

M-13775

1

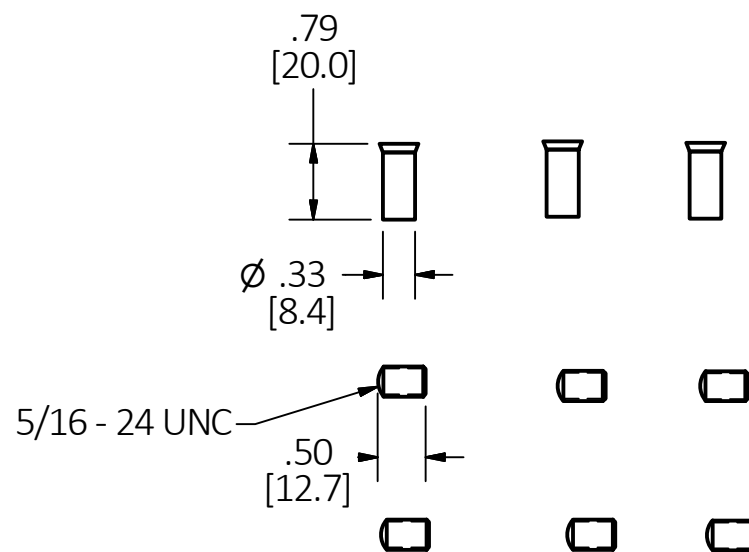
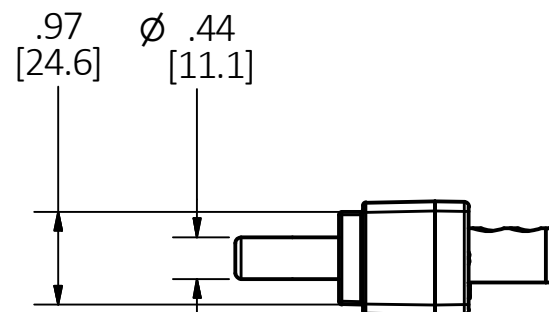
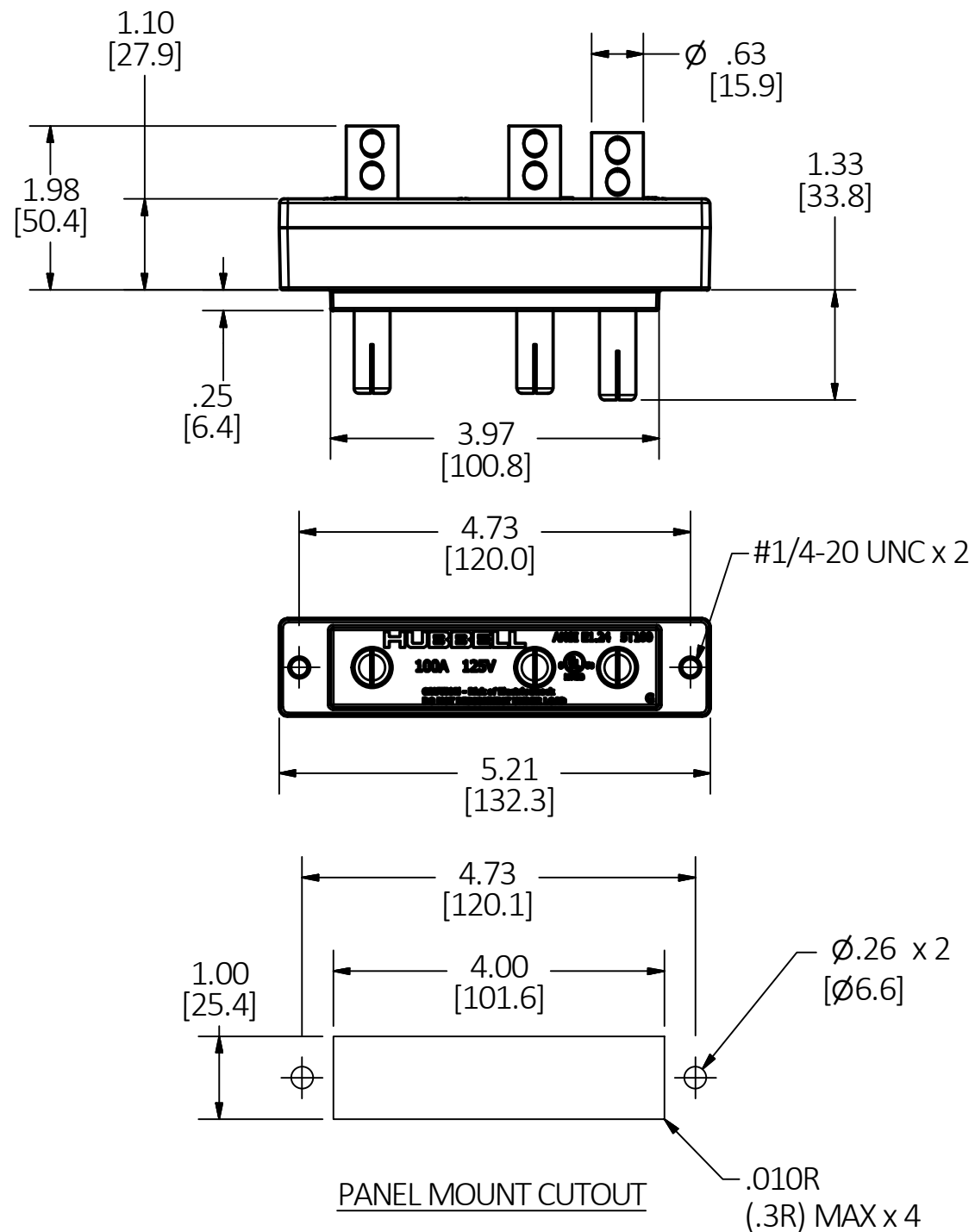

LIST OF PARTS

DESCRIPTION	MATERIAL	FINISH
TOP	NYLON	BLACK
BOTTOM	NYLON	BLACK
MALE CONTACTS	BRASS	BRASS
ASSY SCREWS	STEEL	ZINC
FERRULES	TIN	TIN
SET SCREW	STAINLESS STEEL	PASSIVATED

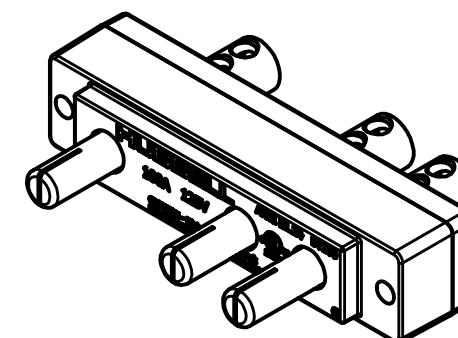

1	ORIGINAL RELEASE PER DCN 23376	PFN	11/6/17
REV	DESCRIPTION	APP	DATE

THE DESIGN AND DIMENSIONS OF THE PRODUCT SHOWN ON THIS DRAWING ARE SUBJECT TO CHANGE WITHOUT NOTICE. DIMENSIONS ARE IN INCHES [mm].

TITLE
100A STAGE PIN PANEL MOUNT DSS MALE



WIRING DEVICE-KELLEMS
HUBBELL INCORPORATED
SHELTON, CT

TOLERANCES UNLESS OTHERWISE SPECIFIED .XX = ± .01 .XXX = ± .005 ANGLE TOL. ±2°	DR. BY PFN	SCALE 1/2
	CHK. BY	DATE 11/6/2017

DIMENSION SHEET FOR CAT. NO. HBL100SPMR

B

M-13775

1

- NOTES:
- DIMENSION ARE IN INCHES (mm) AND ARE FOR REFERENCE ONLY.
 - cULus LISTED AND MEETS ESTA ANSI E1.24 STANDARD
 - WIRE RANGE: #2 AWG, #4 AWG, #6 AWG.
 - FERRULE PROVIDED FOR #2 AWG WIRE. FOR DIFFERENT WIRE SIZE, USE APPROPRIATE UL LISTED FERRULE NOT PROVIDED.
 - SET SCREW TERMINAL TORQUE: 20 IN-LBS.
 - MOUNTING SCREWS: #1/4-20 x 1.25 NOT PROVIDED.