

LIST OF PARTS

DESCRIPTION	MATERIAL	FINISH
FLANGED CASING	.062 STEEL	ALUM SPRY
BRACKET	.062 STEEL	ZINC PLATE
WASHER	.031 STEEL	ZINC PLATE
LIFT COVER	.062 STEEL	ZINC PLATE
LOCKING BRACKET	.025 BRONZE	
GASKETS	RUBBER	
SPRING	.045 S.S. WIRE	
BLADEHOLDER & BASE	COMPOSITION	
CONTACT BLADES	.100 BRASS	
WIRE CLAMP	.100 BRASS	
BIND. SCREWS	STAIN. STEEL	BRASS PL.
GROUNDING SPRING		
BIND. PLATE	.075 BRASS	
GROUNDING SPRING	.025 BRONZE	
WIRE CLAMP	.062 BRASS	

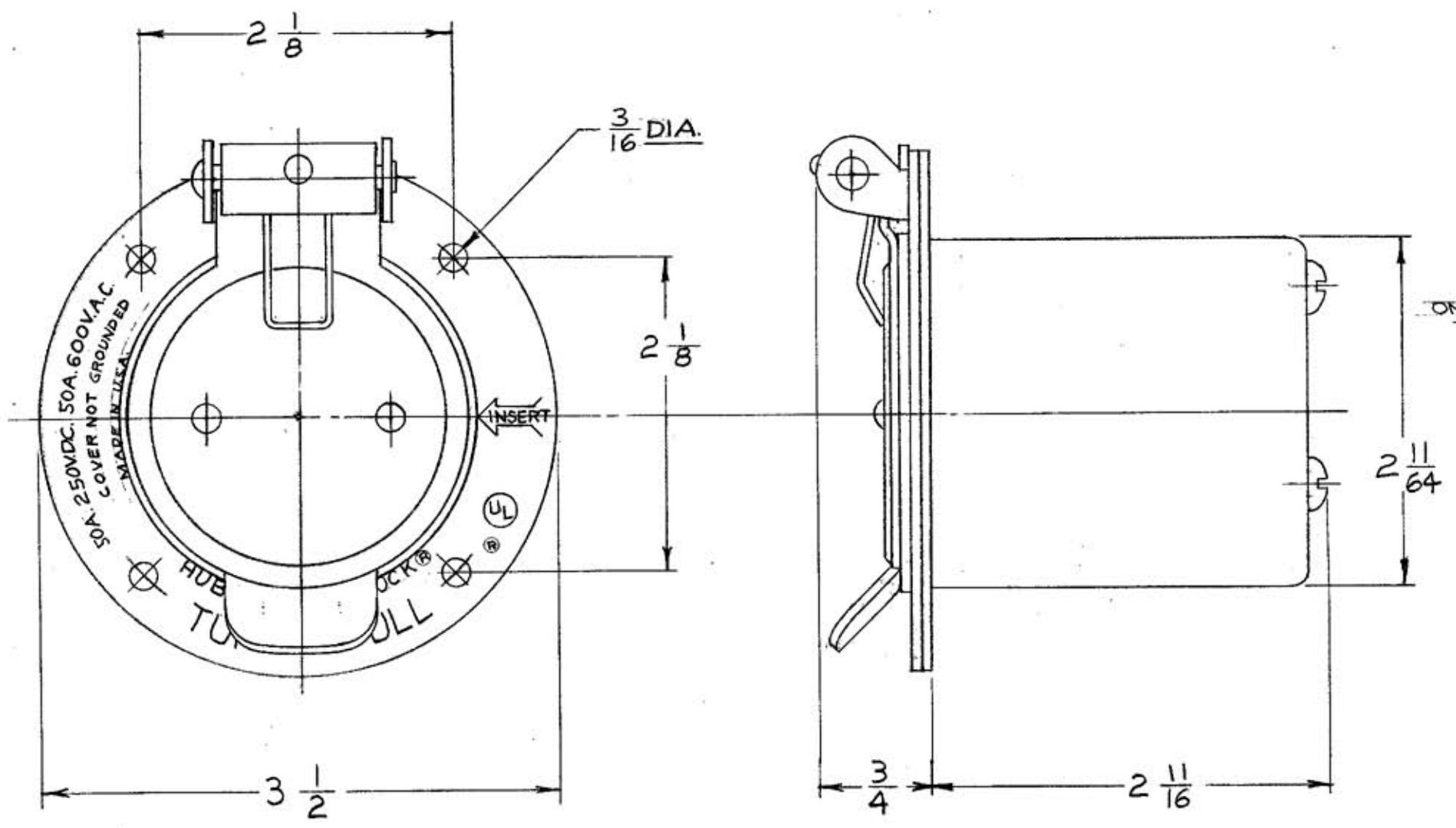

CAT. NO. 7968 4 WIRE - WITH EQUIPMENT GROUND  
 CAT. NOS. WERE 7966, 7967, 7968  
 BIND. SCREW MATERIAL WAS STEEL  
 SUB(2) "X" REMOVED FROM CAT. NO'S.  
 3 CASING THICKNESS WAS .078  
 4 REMOVED GROUNDING SPRING  
 CAT. NOS. 7966, 7967 PER DIM 2243

REVISIONS	DATE
4	10-12-93 AJL
3	7-8-67 ASM
SUB(2) "X"	2-15-66
BIND. SCREW MATERIAL WAS STEEL	10-1-62
CAT. NOS. WERE 7966, 7967, 7968	10-1-62

TOLERANCES UNLESS  
 OTHERWISE SPECIFIED  
 FRACTIONS ± 1/64  
 DECIMALS ± .005  
 ANGLES ± 2°

**HARVEY HUBBELL, INC.**  
 BRIDGEPORT, CONN.  
 DR. BY J.W. APP. BY  
 TR. BY SCALE 1" = 1"  
 CHK'D. BY J.C.H. DATE 6-28-60