

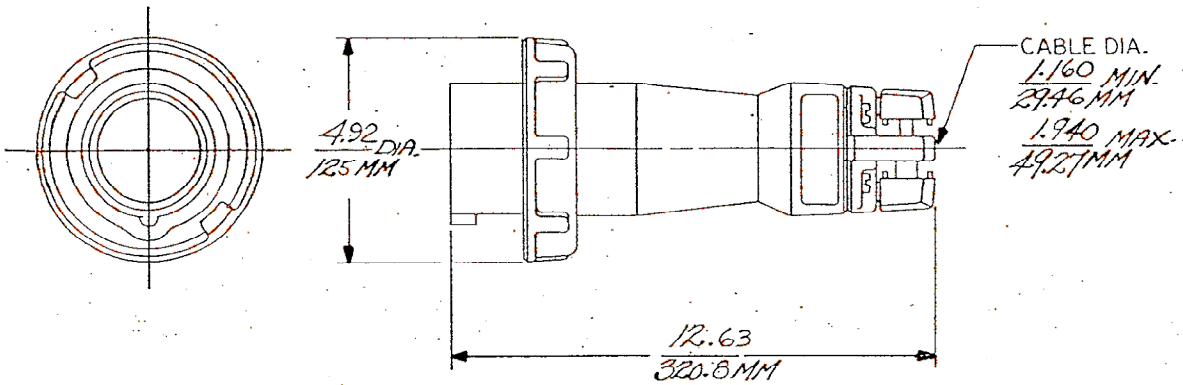

M-7668 1



LIST OF PARTS		
DESCRIPTION	MATERIAL	FINISH
HOUSING	NYLON	
INTERIOR	THERMOSET	
GASKET	RUBBER	
LOCK RING	POLYESTER	
SLEEVES	BRASS	
TERMINAL SCREWS	STAIN. STL	
GLAND CAP	POLYESTER	
GLANDS	RUBBER	
CLAMPS	POLYESTER	
CLAMP NUTS	BRASS	NICKEL
ASSY. SCREWS	STAIN. STL	

CAT. No.	CONFIGURATION	RATING	CAT. No.	CONFIGURATION	RATING
			M4100C12R		100 AMP 125/250 VAC

NOTES:  
1. ALL DECIMAL DIM. TOLS. TO BE ± .03.

TITLE  
100A 4 WIRE  
PIN & SLEEVE  
CONNECTOR

THE DESIGN AND DIMENSIONS OF THE PRODUCT SHOWN ON THIS DRAWING ARE SUBJECT TO CHANGE WITHOUT NOTICE.

1	RELEASE PER DCN 445500X	APP	DATE
SYM	REVISIONS	APP	DATE

TOLERANCES UNLESS OTHERWISE SPECIFIED  
FRACTIONS ± 1/64  
DECIMALS  
ANGLES ± 2°

WIRING DEVICE DIVISION  
HARVEY HUBBELL, INC.  
BRIDGEPORT, CONN.  
DR. BY *Rob* APP. BY  
TR. BY SCALE 1:1  
CHK'D. BY DATE 8-22-96

CODE 74545

DIMENSION SHEET FOR CAT. NO. M-7668  
 REPAIRABLE  NON-REPAIRABLE   
 B  
 M-7668  
 1