

**M-8808**

1

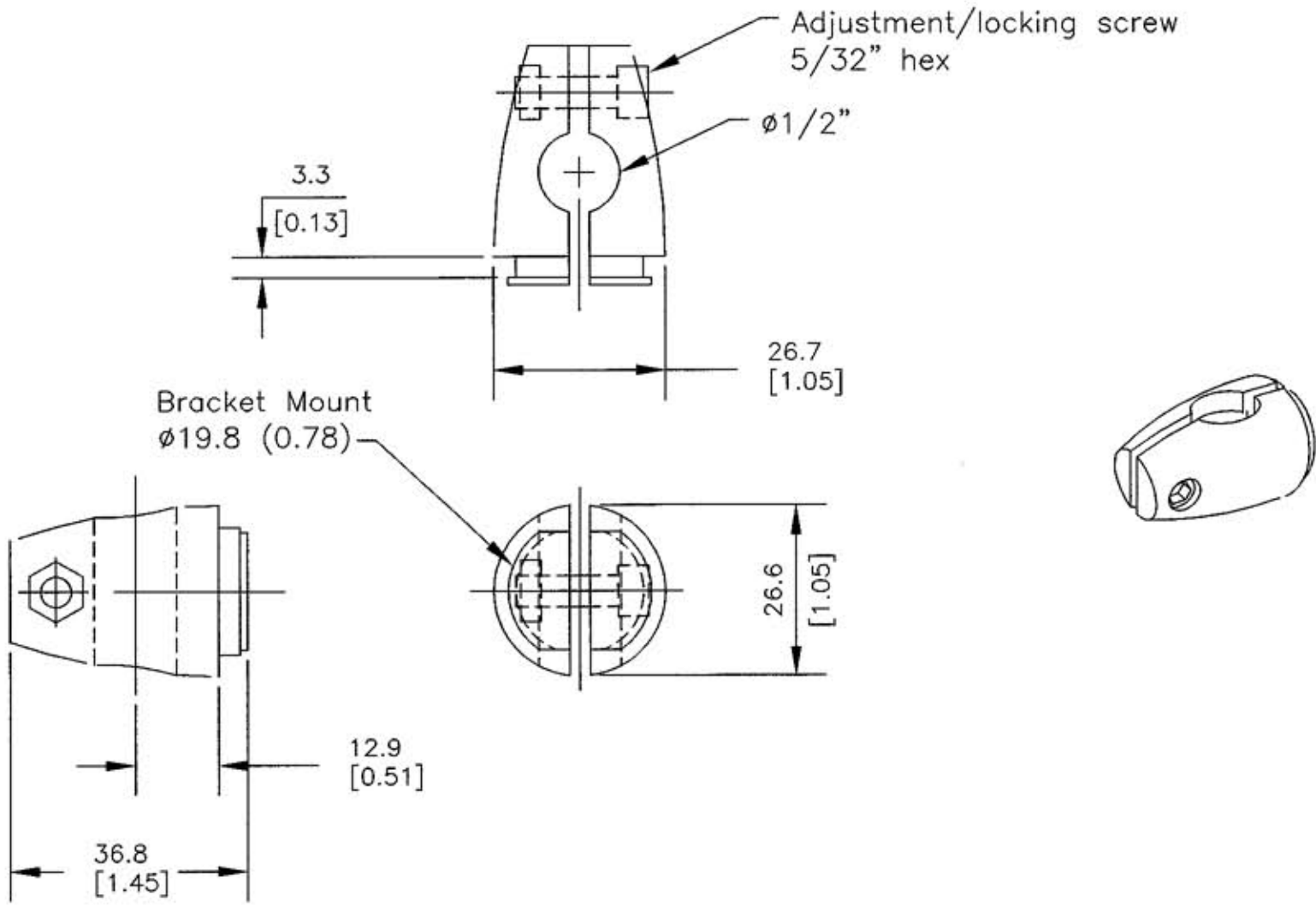

LIST OF PARTS

DESCRIPTION	MATERIAL	FINISH
CLAMP	ZINC DIE CAST	
HARDWARE	STEEL	ZINC PLATED

DIMENSION SHEET FOR CAT. NO. M-8808

REPAIRABLE  NON-REPAIRABLE

1	5/8/02 "X" REMOVED; LAST "X" REVISION WAS X-0. RELEASED FOR PRODUCTION PER DCN #9320. GDR MJL	<i>mjl</i> 5/23/02
---	---	--------------------

SYM	REVISIONS	APP	DATE
-----	-----------	-----	------

THE DESIGN AND DIMENSIONS OF THE PRODUCT SHOWN ON THIS DRAWING ARE SUBJECT TO CHANGE WITHOUT NOTICE

TITLE  
**CLAMP, HALF-KLAMP SET**

TOLERANCES UNLESS OTHERWISE SPECIFIED FRACTIONS $\pm 1/64$ DECIMALS $\pm 0.05$ ANGLES $\pm 2'$	WIRING DEVICE-KELLEMS HUBBELL INCORPORATED BRIDGEPORT, CT		
	DR. BY GDR	APP. BY <i>mjl</i>	
	TR. BY	SCALE NONE	
	CHK'D BY	DATE 5/8/02	

UNLESS OTHERWISE SPECIFIED DIMENSIONS ARE IN mm (INCHES)

**M-8808**