

M-8838 2

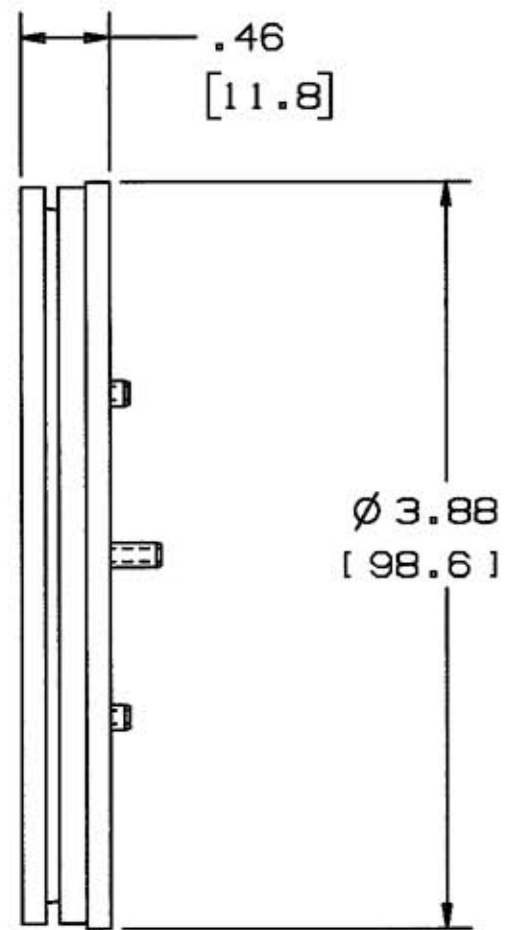
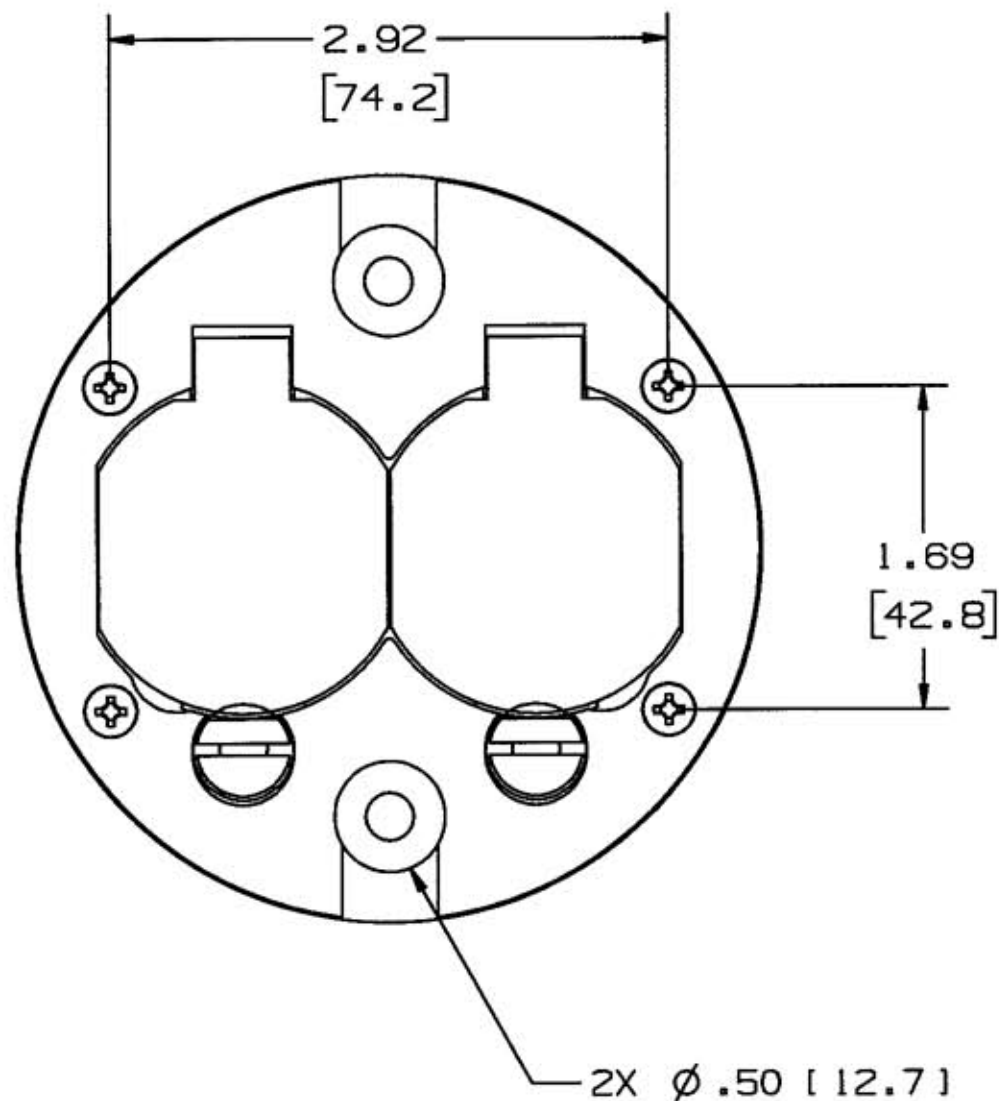

NOTES: (UNLESS OTHERWISE SPECIFIED)

- 1) DIMENSIONS ARE: INCHES [MILLIMETERS]
- 2) .XX TOLERANCES TO BE ± .03

LIST OF PARTS

DESCRIPTION	MATERIAL	FINISH
PLUG, FLAP COVER	BRASS	BRUSH & LACQUER
LOWER FLAP COVER	ABS	BLACK
FLAP COVER TOP	BRASS	BRUSH & LACQUER
FLAP	BRASS	BRUSH & LACQUER
SPRING, FLAP	ST. STEEL	
PIN, HINGE	ST. STEEL	
LOCKING STUD	BRASS	
BUSHING, SNAP	NYLON	BLACK
FLAP GASKET	ELASTOMER	BLACK
COVER GASKET	ELASTOMER	BLACK
#6 SCREW	BRASS	BRIGHT DIP
#6 SCREW	ST. STEEL	PASSIVATED

2	ADDED NOTES 1 & 2. "2X Ø .50 [12.7]" WAS "1/2" DIA 2X"; Ø 3.88 [98.6] WAS Ø 3.90 [99.1]. IN LIST OF PARTS, SCREW MATERIAL "ST. STEEL" WAS "STEEL". CHECKED "NON-REPAIRABLE" BOX PER DCN #12944. JMN	DJP	7/12/06
1	INITIAL RELEASE DCN. 9494	SM	5-29-02
SYM	REVISIONS	APP	DATE

THE DESIGN AND DIMENSIONS OF THE PRODUCT SHOWN ON THIS DRAWING ARE SUBJECT TO CHANGE WITHOUT NOTICE

TITLE
REPLACEMENT BRASS LIFT COVER ASSY.

TOLERANCES UNLESS OTHERWISE SPECIFIED	WIRING DEVICE-KELLEMS HUBBELL INCORPORATED BRIDGEPORT, CT	
FRACTIONS ± 1/64	DR. BY TJV	APP. BY
DECIMALS ± .005	TR. BY	SCALE 1:1
ANGLES ± 2°	CHK'D BY	DATE 5-15-02

DIMENSION SHEET FOR CAT. NO. BRS2RCA

REPAIRABLE NON-REPAIRABLE

B

M-8838

2