

M-8915 2

2X 1/2-20 UNF-2B THD.

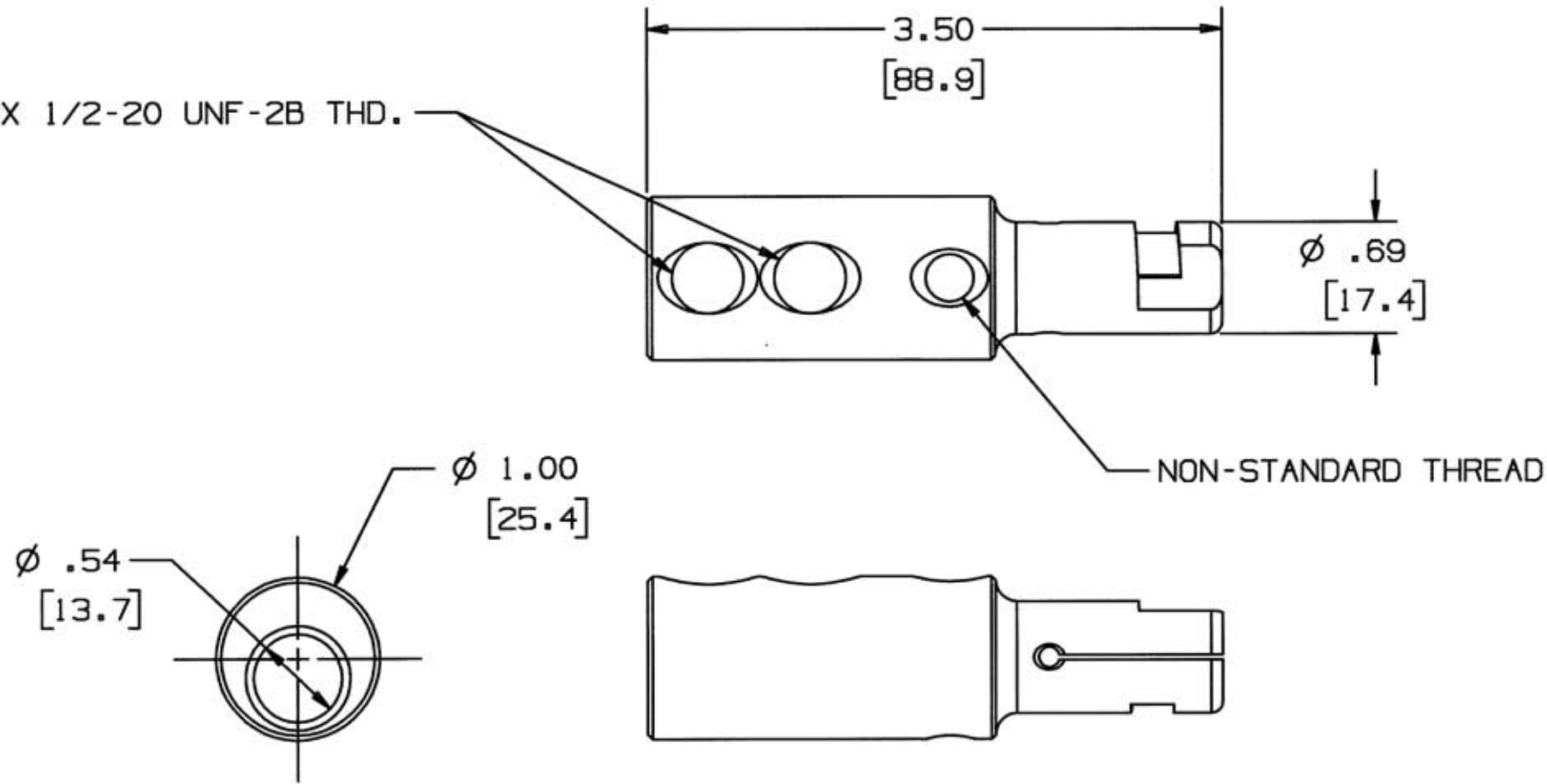

- NOTES:  
 1. DIMENSIONS ARE INCHES ±.02  
 [mm] ±.5  
 2. 300A MAX. CABLE SIZE: #4 AWG - 2/0, COPPER ONLY

LIST OF PARTS

DESCRIPTION	MATERIAL	FINISH
CONTACT	BRASS	

DIMENSION SHEET FOR CAT. NO. HBL300RCM

REPAIRABLE

NON-REPAIRABLE

B

M-8915

2

2	DIM Ø .54 [13.7] WAS Ø .58 [14.7], ADDED REFERENCE SET TO THIS DRAWING & FILE D-58346-01 ADD ±.02 & ±.5 TO NOTE 1 PER DCN 11484 TwB		12/15/04
---	---	--	----------

1	RELEASED PER DCN 10992 MJM TB		6/26/03
---	-------------------------------	--	---------

SYM	REVISIONS	APP	DATE

THE DESIGN AND DIMENSIONS OF THE PRODUCT SHOWN ON THIS DRAWING ARE SUBJECT TO CHANGE WITHOUT NOTICE

TITLE  
300A MALE CONTACT

TOLERANCES UNLESS OTHERWISE SPECIFIED	WIRING DEVICE-KELLEMS HUBBELL INCORPORATED BRIDGEPORT, CT	
FRACTIONS ±1/64	DR. BY MJM	APP. BY
DECIMALS ±.005	TR. BY	SCALE 1:1
ANGLES ±2°	CHK'D BY	DATE 6/11/03