

DESCRIPTION	MATERIAL	FINISH
TOP	POLYCARBONATE	
BASE	POLYESTER	
CONT SP. BIND. PLATE	PHOSPHOR BRONZE	
GR. CONTACT SP.	.031 BRASS	
WIRE CLAMP	.062 STEEL	NICKEL PLATE
BRIDGE	GAV. STEEL	
GROUNDING SPRING	STAINLESS STEEL	
GROUNDING SCREWS	BRASS	
HEX HD. BIND. SCREW	BRASS	GREEN
MOUNTING SCREW	STEEL	ZINC PLATE
WASHER	FIBER	RED
CENTER RIVET	SILICON BRONZE	

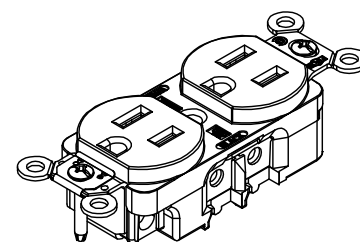

5	PICTORIAL CHANGE TO REFLECT PROPER BASE DCN220110015873 RM	DJP	1/13/22
4	CORRECTED TOP MATERIAL & REDRAWN IN INVENTOR PER DCN 191125075014 RGP	WHD	11/19/19
REV	DESCRIPTION	APP	DATE

THE DESIGN AND DIMENSIONS OF THE  
PRODUCT SHOWN ON THIS DRAWING ARE  
SUBJECT TO CHANGE WITHOUT NOTICE.  
DIMENSIONS ARE IN INCHES [mm].

### 3 WIRE GROUNDING STRAIGHT BLADE DUPLEX RECEPTACLE FOR RING TERMINALS



WIRING DEVICE-KELLEMS  
HUBBELL INCORPORATED  
SHELTON, CT

TOLERANCES UNLESS  
OTHERWISE SPECIFIED  
.XX =  $\pm .01$   
.XXX =  $\pm .005$   
ANGLE TOL.  $\pm 2^\circ$

DR. BY	PFN
CHK. BY	PFN

SCALE	1 : 1
DATE	10/21/2019

5

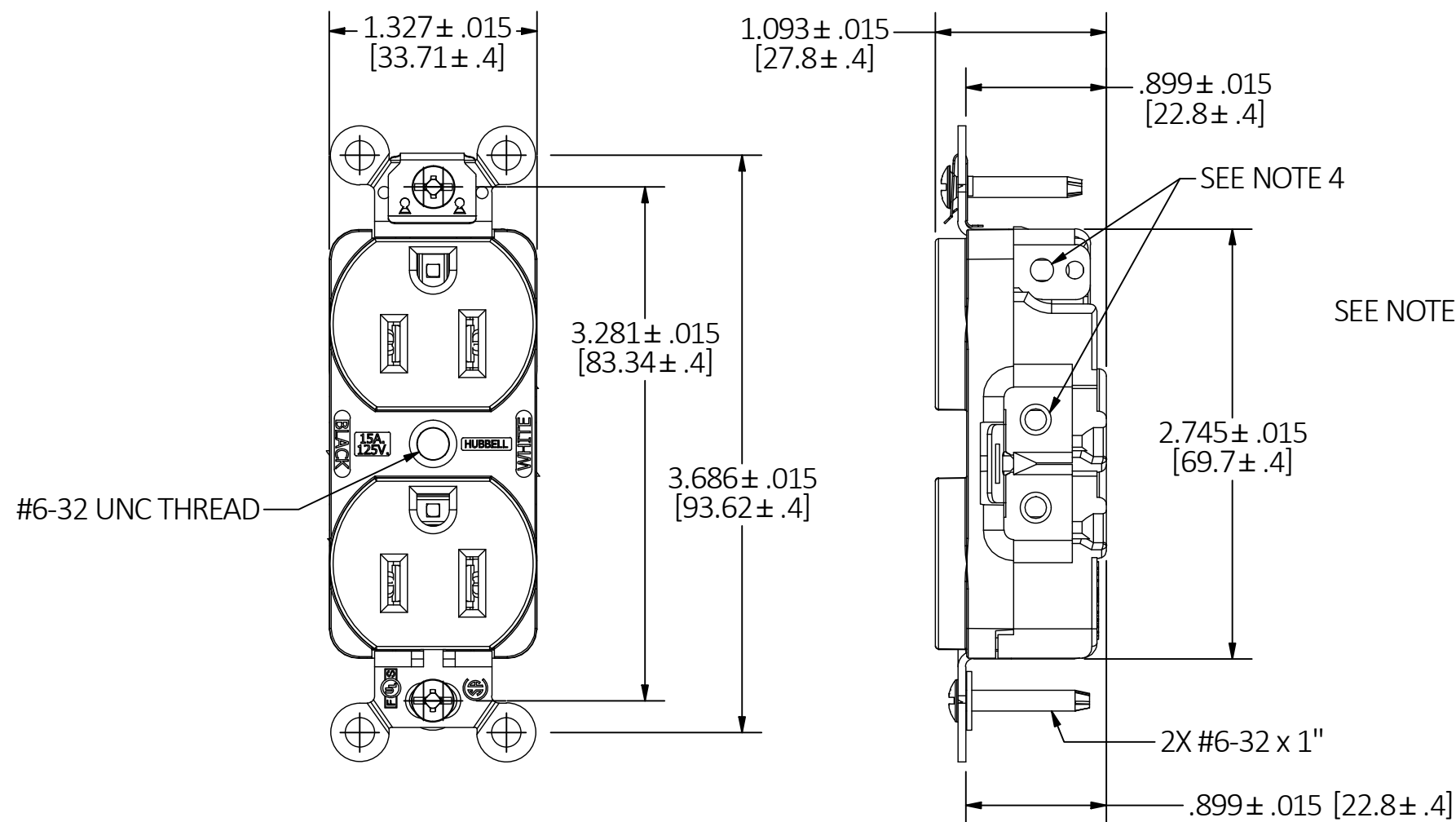

1. DIMENSIONS ARE IN INCHES (mm).
2. ALL DEVICES U.L. LISTED & C.S.A CERTIFIED.
3. TERMINALS ACCOMMODATES #14-10AWG AWG COPPER WIRE ONLY.
4. TERMINAL SCREWS ARE PACKED SEPARATELY IN A POLYBAG.

15A/125V

20A/125V

CATALOG NUMBER	RATING
HBL5242RT	15A/125V
HBL5342RT	20A/125V