

REV	DATE	DESCRIPTION	ECO	BY	C'H'K.
A	6/3/2009 12:00:00 AM	REDRAW INTO PRO-E	17968	DG	MA

D

C

B

A

CATALOG NUMBER	BARREL 'A'					BARREL 'B'					DIE INDEX NO.	HYTOOL™ WITH NUMBER OF CRIMPS PER END				HYPRESS™ WITH NO. OF CRIMPS PER END						
	ACSR		ALUMINUM	COPPER	COLOR CODE	ACSR		ALUMINUM	COPPER	COLOR CODE		MD6	OH25	OUR840	Y750	Y35						
	SIZE	STR.				SIZE	STR.															
ES25R25R	1/0 (.398 DIA.) [10mm DIA.] #1 (.355 DIA.) [9mm DIA.]	6-1 6-1	1/0 STR. (.368 DIA.) [9mm DIA.] 1/0 STR. (.373 DIA.) [9mm DIA.]	1-19 STR. (.332 DIA.) [8mm DIA.] 1/0 STR. (.372 DIA.) [9mm DIA.]	YELLOW	1/0 (.398 DIA.) [10mm DIA.] #1 (.355 DIA.) [9mm DIA.]	6-1 6-1	1/0 STR. (.368 DIA.) [9mm DIA.] 1/0 STR. (.373 DIA.) [9mm DIA.]	1-19 STR. (.332 DIA.) [8mm DIA.] 1/0 STR. (.372 DIA.) [9mm DIA.]	YELLOW	BG OR 5/8	3 BG W-BG	3 	---		X-NBG		U-BG		2 U-BG		
ES25A25A	---	---				---	---		#10 STR. (.373 DIA.) [9mm DIA.] 1/0 COMPR (.362 DIA.) [9mm DIA.] 1/0 COMPACT (.336 DIA.) [9mm DIA.]	#10 STR. (.373 DIA.) [9mm DIA.] 1/0 COMPR (.362 DIA.) [9mm DIA.] 1/0 COMPACT (.336 DIA.) [9mm DIA.]	YELLOW											
ES25A4W	---	---	#10 STR. (.373 DIA.) [9mm DIA.] 1/0 COMPR (.362 DIA.) [9mm DIA.] 1/0 COMPACT (.336 DIA.) [9mm DIA.]	#10 STR. (.373 DIA.) [9mm DIA.] 1/0 COMPR (.362 DIA.) [9mm DIA.] 1/0 COMPACT (.336 DIA.) [9mm DIA.]		YELLOW	#6 (.198 DIA.) [5mm DIA.]	6-1	#5 STR. (.206 DIA.) [5mm DIA.] #6 STR. (.184 DIA.) [5mm DIA.] #4 SOL. (.204 DIA.) [5mm DIA.]	#5 STR. (.206 DIA.) [5mm DIA.] #6 STR. (.184 DIA.) [5mm DIA.] #4 SOL. (.204 DIA.) [5mm DIA.]	BLUE											
ES25A2W						YELLOW	#4 (.250 DIA.) [6mm DIA.] #4 (.257 DIA.) [7mm DIA.]	6-1 7-1	#3 STR. (.260 DIA.) [7mm DIA.] #4 STR. (.232 DIA.) [6mm DIA.] #2 SOL. (.258 DIA.) [7mm DIA.]	#3 STR. (.260 DIA.) [7mm DIA.] #4 STR. (.232 DIA.) [6mm DIA.] #2 SOL. (.258 DIA.) [7mm DIA.]	ORANGE	BG OR 5/8	3 BG W-BG	3 	---		X-NBG		U-BG		2 U-BG	

NOTES:

1. BARREL IS PARTIALLY FILLED WITH PENETROX™ AND SEALED.

2 TWO CRIMPS MADE SIMULTANEOUSLY.

3 MULTIPLE CRIMP DIE SET.

4. MATERIAL: CONNECTOR - ALUMINUM

5. DIMENSIONS IN BRACKETS [] ARE IN MILLIMETERS ROUNDED OFF TO THE NEAREST MILLIMETER, UNLESS OTHERWISE NOTED, AND ARE FOR REFERENCE ONLY.

6. INSTALLATION INSTRUCTIONS:

1. STRIP CABLE INSULATION 7/8" (STRIP LENGTH INDICATED ON INSULINK™). FOR BEST RESULTS, REMOVE COTTON BRAID FOR AN ADDITIONAL 3/4" ON WEATHERPROOF AND SE TYPE CONDUCTORS
2. SCRATCH BRUSHING OF ALUMINUM CONDUCTORS, BEFORE MAKING INSTALLATIONS, IS RECOMMENDED.
3. INSERT CONDUCTOR THROUGH CENTER OF CAP AND THEN PUSH CONDUCTOR SO THAT STRIPPED END SEATS IN CONNECTOR AND INSULATION ENTERS CAP.
4. USING PROPER TOOL, CRIMP BETWEEN GUIDE LINES. MAKE INNERMOST CRIMP FRIST AND CRIMP TOWARD END. REPEAT FOR OTHER-SIDE.

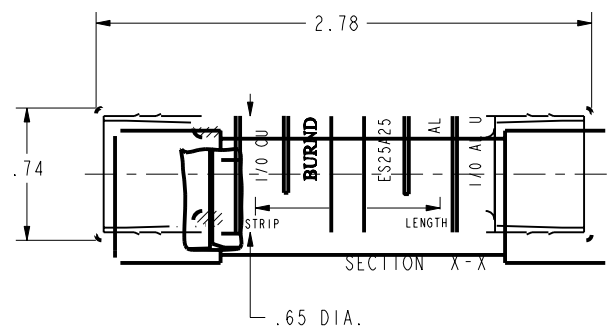

VIEW BEFORE INSTALLATION

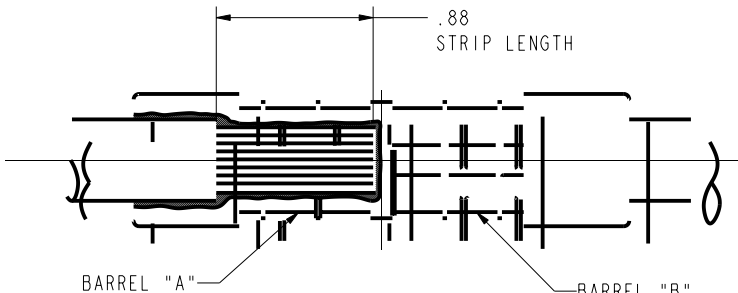
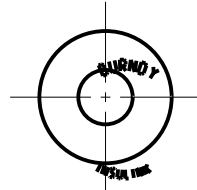

VIEW AFTER INSTALLATION

TO ORDER BURNDY® PRODUCTS CALL

UNITED STATES
1-800-346-4175 (LONDONDERRY, NH)

CANADA:
1-800-361-6975 (QUEBEC)
1-800-387-6487 (ALL OTHER PROVINCES)

FOR PRODUCT INFO: <http://www.burndy.com>

ITEM NO: N/A-BLE

DRAWN BY: JMS (TA 09/02/1958)

CHECKER: TUM 10/15/58

DSN APPVL: ---

MFG APPVL: ---

QA APPVL: ---

MNT APPVL: ---

PROD FAM: ---

PROJECT #: ---

DOCUMENT TYPE: Sales

RHT LEVEL: Released

INSULINK™

DRAWING NO: SD040874

REV: A

SHEET 4 OF 4

REV: PE0200