



HLEBS Series

Hazardous Location Emergency Light

FEATURES

Application

The HLEBS Series is a self-contained hazardous location emergency lighting system which is designed for environments known to have high concentrations of gas, explosive vapors and dust. The HLEBS is intended for use in oil and gas refining, chemical production and storage, grain processing and paint manufacture. The HLEBS provides emergency illumination for a minimum of 90 minutes in the event of power outage. The HLEBS emergency lighting system is available in several configurations with direct mount or remote heads up to 300' from power source. Power is only supplied to the external lamps when AC power is lost. Battery unit must have two heads installed for a total lamp load of 20W (integral or remote up to 300').

Class I, Div. 1 & 2, Groups C, D

Class I, Zones 1 & 2, Groups IIB, IIA

Class II, Div. 1 & 2, Groups E, F, G

Class III, Div. 1 & 2

Type 4 enclosure for NEMA4X and wet location

Construction

The HLEBS Series housing and lamp-heads are made of copper-free (less than 0.4%) aluminum with a baked on electro-statically applied epoxy for maximum corrosion resistance. The housing contains a nickel cadmium battery which delivers 23 watts to power two external 30VDC, 10 watt lamp-heads. The enclosure, lamp-heads and test station utilize 3/4" connection. There are 7 each 3/4" threaded holes in the enclosure.

Installation

Provided with 2 mounting holes at opposing corners for attachment to a wall or other suitable surface. The housing contains 7 each 3/4" drilled and tapped holes for threaded conduit. Quick access to internal wiring and circuitry through a threaded cover with supplied gasket. The HLEBS assembly includes an integral remote test station (push-to-test and AC indicator). The lighting fixtures can be direct pendant, remote pendant, wall or ceiling mount.

Operating Temperature

Battery Unit - 0°C to 45°C (32°F to 113°F)

Remote Lamp-heads - 0°C to 55°C (32°F to 131°F)

Illumination

Illumination is provided by 2 each 30VDC, 10 watt LED lamp-heads in a spot-light or globe type configuration. The EL (globe type) heads provide over 1,000 lumens, and the HK (spot-light) heads provide over 900 lumens per head. Photometric files are available at www.dual-lite.com. LED's are rated for 100,000 hours or 10 years.

Catalog Number	
Comments	Type



Electronics

Voltage input from 120 through 277VAC at 50/60 Hz. Fully automatic solid-state charger which includes low voltage disconnect to prevent deep discharge of the battery. Includes a long-life nickel cadmium battery to provide 30VDC output to power up to 20 watts of load for 90 minutes. An integral AC-on indicator and push-to-test station provides momentary testing of the system and AC-on indication. Front cover includes automatic safety dis-connect of battery power when removed. 15 minute time delay will hold lamps on for approx. 15 minutes after AC power is restored.

Compliances

UL924 Emergency Listed

UL844 Hazardous Location Listed

UL1203 Explosion Proof/Dust-Ignition Proof

Electrical Enclosures

UL1598 Standard for Luminaires

UL8750 LED Lighting

Warranty

Full 3 year warranty

Power Consumption

Input*			Output*		
Voltage	Watts	Current	Voltage	Watts	Current
120-277VAC	7.5	.1A	33VDC	23	700mA

Figures nominal. Current is 350mA to each of 2 heads (2 heads are required for proper operation, remote or attached)

ORDERING GUIDE

HLEBS

Model	Capacity	Test Options	Time Delay	Lamp-Head Options	Lamp-Head Options
	23DH 23 watts with two heads for 90 minutes	P Integral PTT on Enclosure R Remote PTT station N None	T 15 Minute Time Delay (120 or 277VAC) N No Time Delay		D Drain Included Blank No Drain Included
Lamp-Head Options					
N No heads - For Remote Heads Ordered Separately A 2 HLEBSHK1030 Heads Factory Attached BG 2 HLEBSEL1030 Heads with Guards and Fittings for Attachment BE 2 HLEBSEL1030 Heads with 1 Guard and 1 HEXA-100 EXIT and Fittings for Attachment CG 1 HLEBSHK1030 Heads Attached and 1 HLEBSEL1030 Head with Guard and Fittings for Attachment CE 1 HLEBSHK1030 Heads Attached and 1 HLEBSEL1030 Head with HEXA-100 EXIT and Fittings for Attachment D 1 HLEBSHK1030 Only (2nd Head Remote - Ordered Separately) EG 1 HLEBSEL1030 Only with Guard and Fittings for Attachment (2nd Head Remote - Ordered Separately) EE 1 HLEBSEL1030 Only with HEXA100 EXIT and Fittings for Attachment (2nd Head Remote - Ordered Separately)					



HLEBS Series

Hazardous Location Emergency Light



N-No head



A- HK Heads Attached



BG-EL Heads Attached



BE-EL Heads and Exit Acc.



CG-HK and EL Heads



CE-HK Head and EL w/ Exit Acc.

REMOTE HEAD MOUNTING OPTIONS (ORDERED SEPARATELY)



Pendant



Ceiling



Wall

EL Remote Heads 10W 30VDC

	Pendant 3/4"	Ceiling 3/4"	Wall 3/4"
With Guard	HLEBSEL1030A2G	HLEBSEL1030X2G	HLEBSEL1030B2G
Without Guard	HLEBSEL1030A2	HLEBSEL1030X2	HLEBSEL1030B2

Classification: CID1CD; CIID1EFG



EBSHK1030-RFSC



EBSHK1030-RFSL

HK Remote Heads 10W 30VDC

HK Head with Adjustable Factory Sealed "C" fittings set	HLEBSHK1030-RFSC
HK Head with Adjustable Factory Sealed "L" fittings set	HLEBSHK1030-RFSL

Classification: CID1D; CIID1EFG

ACCESSORIES

HLEBSEL1030 Components & Accessories

	Catalog Number
Guard	EMG1
Red Guard- used to signify remote fixture is for Emergency	EMG1-R
EXIT Accessory- 3 sided white painted aluminum	HEXA-100
Dome Reflector	ERSD15
Angle Reflector	ERA15



EMG1-R EMG1



ERSD15

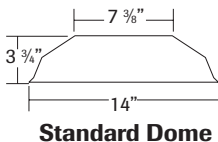

ERA15

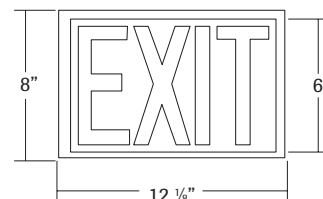
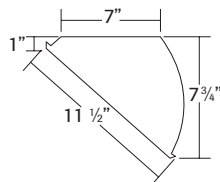

Exit Sign

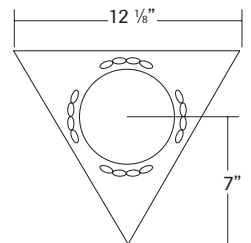

Exit Accessory



HLEBS Series

Hazardous Location Emergency Light

DIMENSIONS

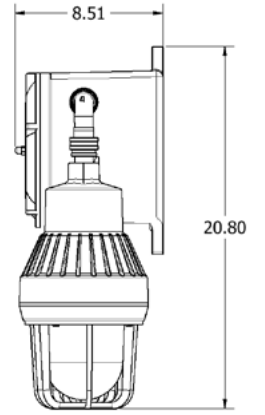
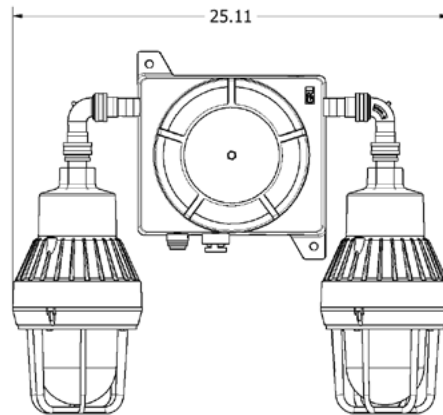
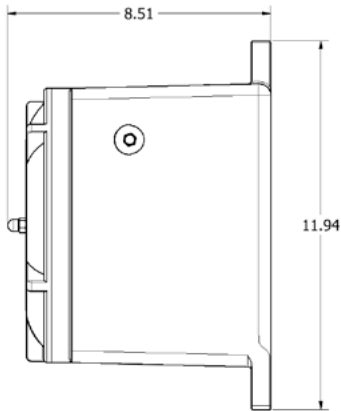
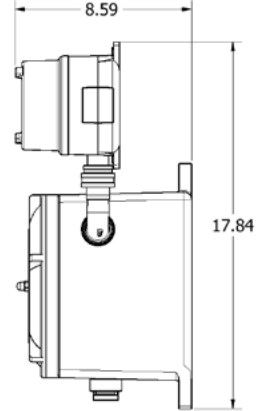
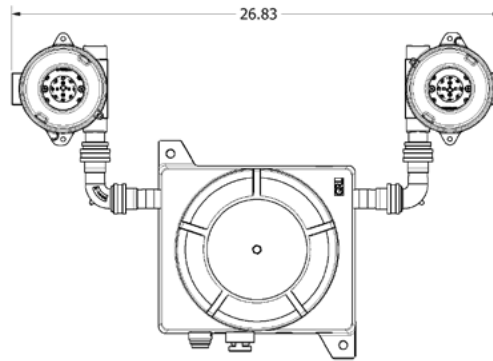
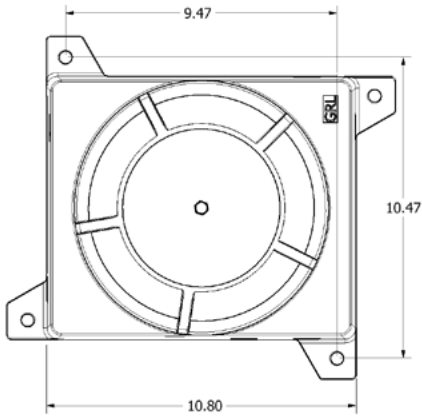

Pendant

Ceiling

Wall

HLEBS Unit- Bottom Detail

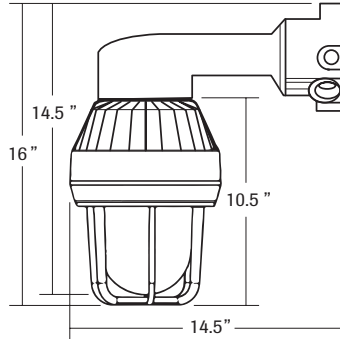
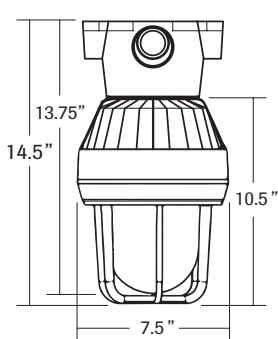
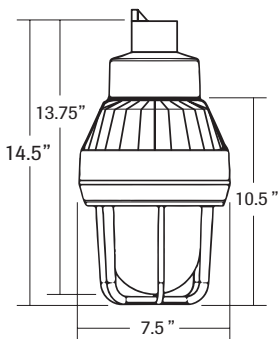

1. Optional Push-To-Test
2. Optional Group B Drain
3. Standard Pilot Light
4. Entry for Remote P-T-T Station
5. Power Entry (also on top)