

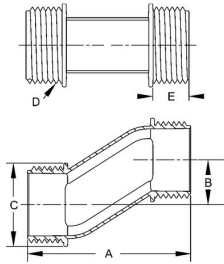

NIPPLES

Offset Nipples Die Cast Zinc
N/A

B90



Catalog #: 1455

APPLICATIONS

For use when connecting two boxes or panels when the knockouts are not in line.
N/A

PRODUCT FEATURES

Creates a 3/4 inch offset connection.
Rugged metallic construction provides mechanical protection for the conductors.

UL LISTED

Standard 514B, File E195969

CSA

C22.2 No. 18

GENERAL PRODUCT INFORMATION

Trade Size: 1-1/4 in.

DRAWING DIMENSIONS

Dimension A:	2-13/16 in.
Dimension B:	3/4 in.
Dimension C:	1-13/16 in.
Dimension D:	1-1/4 in. - 11-1/2 NPSM
Dimension E:	19/32 in.

PACKAGING

Package Type:	Carton
Ship Carton Qty.:	10
Product UPC-A Labeled:	No
Weight (Lbs. Per/C):	35.60
Ship Carton Length (in.):	7.45
Ship Carton Width (in.):	5.37
Ship Carton Height (in.):	5.45
Ctn Weight (Lbs.):	3.56
UPC Number:	050169014554
I2of5:	50050169014559