

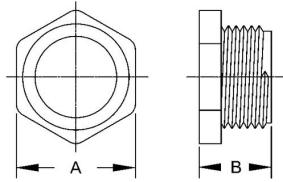

NIPPLES

Uninsulated Chase Nipples Die Cast Zinc
N/A

B90



Catalog #: 1662

APPLICATIONS

For use with a conduit coupling to connect conduit to a box, or with a locknut to connect two boxes.
N/A

PRODUCT FEATURES

Rugged metallic construction

UL LISTED

Standard 514B, File E195969

CSA

C22.2 No. 18

GENERAL PRODUCT INFORMATION

Trade Size: 1/2 in.

DRAWING DIMENSIONS

Dimension A: 15/16 in.

Dimension B: 19/32 in.

PACKAGING

Package Type:	Carton
Std. Pkg.:	100
Ship Carton Qty.:	1000
Product UPC-A Labeled:	No
Weight (Lbs. Per/C):	3.10
Ship Carton Length (in.):	19.00
Ship Carton Width (in.):	10.62
Ship Carton Height (in.):	5.31
Ctn Weight (Lbs.):	31.00
UPC Number:	050169016626
I2of5:	50050169016621