

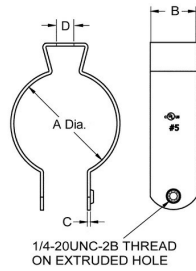

## CONDUIT HANGERS

Conduit Hangers with Threaded Hole, Steel  
N/A

B84

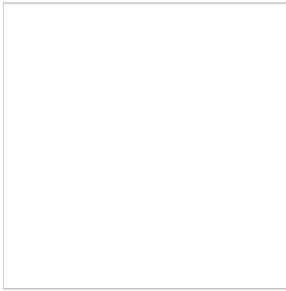

Catalog #: 2055TH

### APPLICATIONS

For use in wet or dry locations to support runs of rigid/IMC and EMT conduit from ceilings and walls  
N/A

### PRODUCT FEATURES

Hangers are supplied with a retained bolt and threaded hole eliminating the need for a nut  
The design allows for quick and easy installation using a screwdriver or nut driver  
Pregalvanized finish provides corrosion protection

### CULUS

UL Listed E195968

### GENERAL PRODUCT INFORMATION

Trade Size:	3
Rigid/IMC Size:	1-1/4 in.
EMT Size:	1-1/2 in.
Max Load Lbs.:	80

### DRAWING DIMENSIONS

Dimension A:	1.71 in.
Dimension B:	1.00 in.
Dimension C:	.055 - .062 in.
Dimension D:	.33 in.

### PACKAGING

Package Type:	Carton
Ship Carton Qty.:	100
Product UPC-A Labeled:	No
Weight (Lbs. Per/C):	14.20
Ship Carton Length (in.):	10.40
Ship Carton Width (in.):	10.40
Ship Carton Height (in.):	4.80
Ctn Weight (Lbs.):	14.60
UPC Number:	050169911945
I2of5:	50050169911940