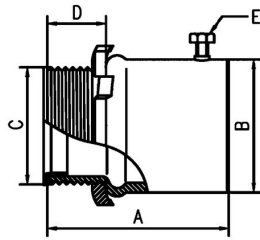

**EMT SET SCREW CONNECTORS**

Insulated Set Screw Connector, Steel

**B03**

Catalog #: 2124

**APPLICATIONS**

For use in dry locations to bond EMT conduit to a box or enclosure. RACO steel set screw connectors provide concrete-tight connections when taped.

**PRODUCT FEATURES**

- All steel construction insures mechanical protection for the raceway
- Tri-head screws may be installed using a slotted, Phillips, or Robertson head screwdriver
- 2-1/2 in. to 4 in. trade sizes are also UL listed for use on Rigid/IMC conduit, allowing for design and installation flexibility
- All components are zinc electroplated for corrosion protection
- 1/2 in. to 1 in. trade sizes have one set screw, 1-1/4 in. to 4 in. trade sizes have two set screws
- UPC bar coded fittings are individually polybagged with a preprinted UPC-A bar code, and packaged in pre-scored tear top cartons for an attractive presentation

**UL LISTED**

2-1/2" - 4" Standard 514B, File E195969, E195970

**CULUS**

1/2" - 2" Standard 514B, C22.2 # 18

**COMPLIANCES**

MSDS  
[www.hubbell-rtb.com/certifications/Hubbell-RACO\\_MSDS\\_for\\_WP\\_Boxes\\_and\\_Fittings\\_January\\_2015.pdf](http://www.hubbell-rtb.com/certifications/Hubbell-RACO_MSDS_for_WP_Boxes_and_Fittings_January_2015.pdf)

**GENERAL PRODUCT INFORMATION**

Sub Class: Insulated  
 Trade Size: 1 in.

**DRAWING DIMENSIONS**

Dimension A: 1.81"  
 Dimension B: 1.194"  
 Dimension D: .391"  
 Dimension E: #12-28UNF

**PACKAGING**

Package Type: Carton  
 Std. Pkg.: 25  
 Ship Carton Qty.: 100  
 Product UPC-A Labeled: No  
 Weight (Lbs. Per/C): 20.3  
 Ship Carton Length (in.): 10.00  
 Ship Carton Width (in.): 5.25  
 Ship Carton Height (in.): 4.31  
 Ctn Weight (Lbs.): 20.28  
 Pallet Qty: 4800  
 UPC Number: 050169021248