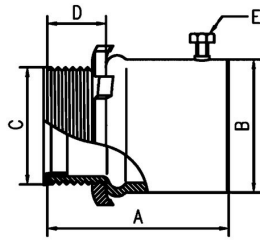

**EMT SET SCREW CONNECTORS****Uninsulated Set Screw Connector, Steel****B03**

Catalog #: 2142

APPLICATIONS

For use in dry locations to bond EMT conduit to a box or enclosure. RACO steel set screw connectors provide concrete-tight connections when taped.
 For use in dry locations to bond unthreaded rigid/IMC conduit to a box or enclosure. RACO steel set screw connectors provide concrete-tight connections when taped.

PRODUCT FEATURES

- All steel construction ensures mechanical protection for the raceway
- Tri-head screws may be installed using a slotted, Phillips, or Robertson head screwdriver
- 2-1/2 in. to 4 in. trade sizes are also UL listed for use on EMT or Rigid/IMC conduit, allowing for design and installation flexibility
- All components are zinc electroplated for corrosion protection
- 1/2 in. to 1 in. trade sizes have one set screw, 1-1/4 in. to 4 in. trade sizes have two set screws
- UPC bar coded fittings are individually polybagged with a preprinted UPC-A bar code, and packaged in pre-scored tear top cartons for an attractive presentation

UL LISTED

2-1/2" - 4" Standard 514B, File E195969, E195970
 Standard 514B, UL Listed E195969

CULUS

1/2" - 2" Standard 514B, C22.2 # 18

COMPLIANCES

MSDS
www.hubbell-rtb.com/certifications/Hubbell-RACO_MSDS_for_WP_Boxes_and_Fittings.January_2015.pdf

GENERAL PRODUCT INFORMATION

Sub Class: Uninsulated
 Trade Size: 3 in.

DRAWING DIMENSIONS

Dimension A: 3.30"
 Dimension B: 3.555"
 Dimension D: .654"
 Dimension E: 1/4 - 28

PACKAGING

Package Type: Carton
 Ship Carton Qty.: 1
 Product UPC-A Labeled: No
 Weight (Lbs. Per/C): 155
 Ship Carton Length (in.): 4.88
 Ship Carton Width (in.): 4.88
 Ship Carton Height (in.): 4.31
 Ctn Weight (Lbs.): 1.71
 Pallet Qty: 648
 UPC Number: 050169021422