

Fixture Type:

Project Name:

Ordering Guide

Feature	Code	Options	Description
Series		22	MOD
Mounting		W	Wall-Mount
Fixture distribution		D	Direct
Row length (in feet)		____'	Enter in foot increments. Note fixture lengths below.
Max length in row		03 04 06 08 12	3', 914mm 4', 1219mm 6', 1829mm 8', 2438mm 12', 3658mm
Downlight diffuser		BW SGL	Blade Baffle, White Soft Glow Lens
Finish/Color		C1 C2 C3 C4 C5 C6 CC	Matte White Textured Matte White (Default) Light Silver Machined Aluminum Carbon Black Textured Camera Black Custom Color
Lamping		1T5 1T5HO 1T8	T5 Lamping T5HO Lamping T8 Lamping
Ballast (non-dimming TS/HO)		NPN	Electronic, program-start
Ballast (non-dimming T8)		NIN NPN NIL NPL NIH NPH	Electronic Electronic, program-start Electronic, low wattage Electronic, low-wattage, program-start Electronic, high light output Electronic, high light output, program-start
Ballast (dimming)		010V LVD DALI LLS	0-10V Dimming Line Voltage Dimming Dali System Light Level Switching 50/100 See <i>Ballast</i> section for additional dimming ballast options
Circuiting		1C AC AF	1 Circuit Alternate Lamp Compartment Switch Alternate Fixture Switching
Voltage		UNV 120 277 347	Universal Voltage 120 Volt 277 Volt 347 Volt
Optional Features	Code	Options	Description
Nightlight		_NL	Nightlight Circuit Required. Enter quantity. 2NL = 2 nightlight circuits/row
Emergency		_EF	Emergency Battery Required. Enter quantity. 2EF = 2 emergency batteries/row
Thru-wiring		W1 W2 W3 W4	No Thru Wire Provide Normal and Emergency Thru Wiring* Provide Normal Thru Wiring Only Provide Emergency Thru Wiring Only *Only applicable when specified with emergency
Fuse		F	Fuse

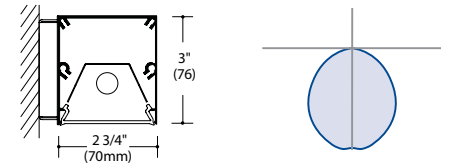

Key Features

- Small form factor

Details

Construction:

Housing-extruded aluminum.
End caps-flat. Steel.

Diffuser Options:

BW Blade Baffle, textured matte white.
SGL Soft Glow Lens, extruded frosted acrylic.

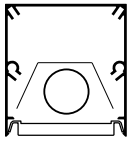

BW baffle
(T8 Shown)

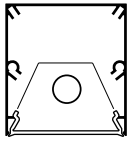

SGL
(T5 Shown)

Row Joining:

Fixture end headers are threaded in two locations to allow easy row joining.

Distribution:

0/100 (1-lamp) direct.

Finish/Color:

Visit www.litecontrol.com/finishes for details.

Lamping:

Available in one-lamp T8, T5 and T5HO cross-sections.



1-T5 or T5HO



1-T8

Ballast:

Electronic, high power factor, thermally protected Class P, Sound Rated A, less than 10% THD, manufactured by a UL Listed manufacturer, as available, determined by Litecontrol. Ballasts with a voltage range of 120 to 277 will be used when fixture configuration and ballast availability allow. The minimum number of ballasts will be used.

Additional Dimming Ballast Options:

LE30	Lutron EcoSystem-3 Wire	<i>(Normal Ballast Factor)</i>
LEH0	Lutron EcoSystem-H Series	<i>(Normal Ballast Factor)</i>
LEH7	Lutron EcoSystem-H Series	<i>(High Ballast Factor)</i>
LEI0	Lutron EcoSystem-Intelligent	<i>(Normal Ballast Factor)</i>
LH3D	Lutron HiLume 3D-3 Wire	<i>(Normal Ballast Factor)</i>
LH37	Lutron HiLume 3D-3 Wire	<i>(High Ballast Factor)</i>
LHHL	Lutron HiLume-Traditional	<i>(Normal Ballast Factor)</i>
LHID	Lutron HiLume-3D Intelligent	<i>(Normal Ballast Factor)</i>
LH17	Lutron HiLume-3D Intelligent	<i>(High Ballast Factor)</i>
LE30	Lutron EcoSystem-3 Wire	<i>(Normal Ballast Factor)</i>

Circuiting:

1C (1 Circuit) Fixture wired for a single circuit.
AC (alternate lamp compartment switching) Fixtures wired so every other lamp section can be separately switched/dimmed
AF (alternate fixture switching) Fixtures wired so every other fixture segment can be separately switched/dimmed.

Nightlight:

See separate LC-Nightlight spec sheet for additional details.

Emergency:

Battery-powered ballast from a listed manufacturer will operate one lamp for 90 minutes.

Thru wiring:

See separate LC-Thruwire spec sheet for additional details.

Fuse:

Slow or fast blow; determined by Litecontrol.

Ratings:

UL listed for damp locations. IBEW. AF of L.

Warranty:

1 year
see www.litecontrol.com for details

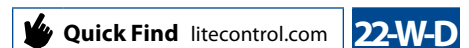

Details

Planning for installation

Wall Bracket Detail

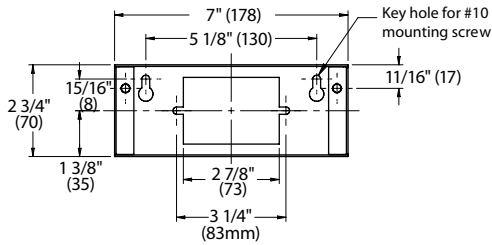

Row Diagram

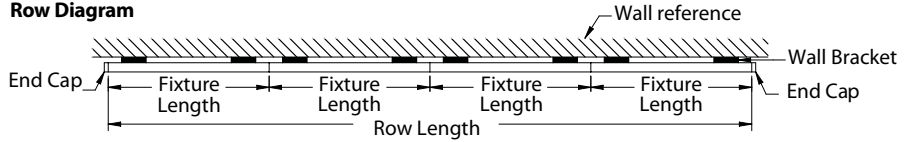

Fixture Side View

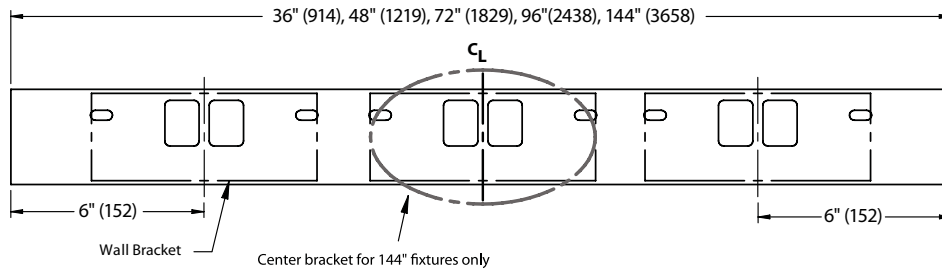

Fixture Lengths: 3', 4', 6' 8' or 12'

○ = 11/16" Mounting slots for wall bracket

□ = Cutouts for electrical feed locations

Quick Find litecontrol.com **22-W-D**