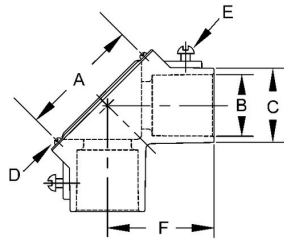

**EMT HANDY ELLS - DIE CAST ZINC****90 Degree Handy Ells Female-Female Die Cast Zinc  
N/A****B13**

Catalog #: 2753

**APPLICATIONS**For use in dry locations to couple two ends of EMT conduit  
Use handy ells when bending conduit is not practical**PRODUCT FEATURES**Cover and screws included  
Rugged metallic construction provides mechanical protection for the raceway  
N/A**UL LISTED**

File E195969

**CSA**

C22.2 No. 18

**GENERAL PRODUCT INFORMATION**

Trade Size: 3/4 in.

**DRAWING DIMENSIONS**

Dimension A:	1-13/16 in.
Dimension B:	15/16 in.
Dimension C:	1-3/16 in.
Dimension D:	8-32 x 1/4 in.
Dimension E:	10-32 x 5/16 in.
Dimension F:	1-13/32 in.

**PACKAGING**

Package Type:	Carton
Std. Pkg.:	5
Ship Carton Qty.:	50
Product UPC-A Labeled:	No
Weight (Lbs. Per/C):	31.20
Ship Carton Length (in.):	19.00
Ship Carton Width (in.):	10.63
Ship Carton Height (in.):	4.13
Ctn Weight (Lbs.):	15.60
UPC Number:	050169027530
I2of5:	50050169027535