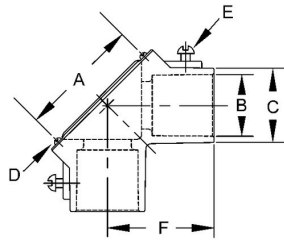

**EMT HANDY ELLS - DIE CAST ZINC****90 Degree Handy Ells Female-Female Die Cast Zinc
N/A****B13**

Catalog #: 2754

APPLICATIONS

For use in dry locations to couple two ends of EMT conduit
Use handy ells when bending conduit is not practical

PRODUCT FEATURES

Cover and screws included
Rugged metallic construction provides mechanical protection for the raceway
N/A

UL LISTED

File E195969

CSA

C22.2 No. 18

GENERAL PRODUCT INFORMATION

Trade Size: 1 in.

DRAWING DIMENSIONS

Dimension A: 2-51/64 in.
Dimension B: 1-3/16 in.
Dimension C: 1-35/64 in.
Dimension D: 8-32 x 1/4 in.
Dimension E: 1/4-20 x 1/2 in.
Dimension F: 1-27/32 in.

PACKAGING

Package Type: Carton
Ship Carton Qty.: 25
Product UPC-A Labeled: No
Weight (Lbs. Per/C): 68.00
Ship Carton Length (in.): 8.68
Ship Carton Width (in.): 8.70
Ship Carton Height (in.): 6.20
Ctn Weight (Lbs.): 17.00
UPC Number: 050169027547
I2of5: 50050169027542