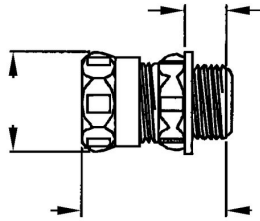

**EMT COMPRESSION CONNECTORS**

Compression Connectors, Steel

B05

Catalog #: 2904-8

APPLICATIONS

For use to bond EMT conduit to a box or enclosure.
 RACO Compression connectors are suitable for applications above 600V.

PRODUCT FEATURES

1/2 in. to 4 in. connectors provide concrete-tight connections
 All steel construction ensures mechanical protection for the raceway
 All components are zinc electroplated for corrosion protection
 UPC bar coded fittings are individually polybagged with a preprinted UPC-A bar code, and packaged in pre-scored tear top cartons for an attractive presentation.

CULUS

Standard 514B, UL Listed E195970, C22.2 No. 1

COMPLIANCES

MSDS
www.hubbell-rtb.com/certifications/Hubbell-RACO_MSDS_for_WP_Boxes_and_Fittings,January_2015.pdf

GENERAL PRODUCT INFORMATION

Sub Class: Uninsulated
 Trade Size: 1 in.

DRAWING DIMENSIONS

Dimension A: 1.90 in.
 Dimension B: .56 in.
 Dimension C: 1.64 in.

PACKAGING

Package Type: Carton
 Std. Pkg.: 1
 Ship Carton Qty.: 10
 Product UPC-A Labeled: Yes
 Weight (Lbs. Per/C): 27.00
 Ship Carton Length (in.): 6.25
 Ship Carton Width (in.): 4.50
 Ship Carton Height (in.): 4.25
 Ctn Weight (Lbs.): 2.70
 UPC Number: 050169290484
 I2of5: 50050169290489