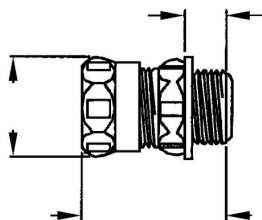

**EMT COMPRESSION CONNECTORS**

Compression Connectors, Steel

B05

Catalog #: 2914-8

APPLICATIONS

For use to bond EMT conduit to a box or enclosure.
RACO Compression connectors are suitable for applications above 600V.

PRODUCT FEATURES

1/2 in. to 4 in. connectors provide concrete-tight connections
All steel construction ensures mechanical protection for the raceway
All components are zinc electroplated for corrosion protection
UPC bar coded fittings are individually polybagged with a preprinted UPC-A bar code, and packaged in pre-scored tear top cartons for an attractive presentation.

CULUS

Standard 514B, UL Listed E195970, C22.2 No. 1

COMPLIANCES

MSDS
www.hubbell-rtb.com/certifications/Hubbell-RACO_MSDS_for_WP_Boxes_and_Fittings,January 2015.pdf

GENERAL PRODUCT INFORMATION

Sub Class: Insulated
Trade Size: 1 in.

DRAWING DIMENSIONS

Dimension A: 1.90 in.
Dimension B: .56 in.
Dimension C: 1.64 in.

PACKAGING

Package Type: Carton
Std. Pkg.: 1
Ship Carton Qty.: 10
Product UPC-A Labeled: Yes
Weight (Lbs. Per/C): 24.00
Ship Carton Length (in.): 6.25
Ship Carton Width (in.): 4.50
Ship Carton Height (in.): 4.25
Ctn Weight (Lbs.): 2.40
UPC Number: 050169291481
I2of5: 50050169291486