

**EMT COMPRESSION CONNECTORS**

Compression Connectors, Steel

B05

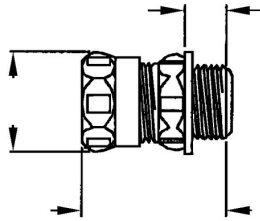

Catalog #: 2918

APPLICATIONS

For use to bond EMT conduit to a box or enclosure.
RACO Compression connectors are suitable for applications above 600V.

PRODUCT FEATURES

1/2 in. to 4 in. connectors provide concrete-tight connections
All steel construction ensures mechanical protection for the raceway
All components are zinc electroplated for corrosion protection
UPC bar coded fittings are individually polybagged with a preprinted UPC-A bar code, and packaged in pre-scored tear top cartons for an attractive presentation.

CULUS

Standard 514B, UL Listed E195970, C22.2 No. 1

COMPLIANCES

MSDS
www.hubbell-rtb.com/certifications/Hubbell-RACO_MSDS_for_WP_Boxes_and_Fittings,January_2015.pdf

GENERAL PRODUCT INFORMATION

Sub Class: Insulated
Trade Size: 2 in.

DRAWING DIMENSIONS

Dimension A: 2.40 in.
Dimension B: .66 in.
Dimension C: 2.74 in.

PACKAGING

Package Type: Carton
Ship Carton Qty.: 20
Product UPC-A Labeled: No
Weight (Lbs. Per/C): 62.40
Ship Carton Length (in.): 12.88
Ship Carton Width (in.): 8.75
Ship Carton Height (in.): 5.63
Ctn Weight (Lbs.): 12.48
UPC Number: 050169029183
I2of5: 30050169029184