

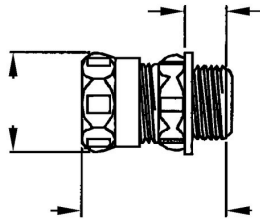

**EMT RAINTIGHT COMPRESSION CONNECTORS**

Compression Connectors, Raintight Steel  
N/A

**B07**



Catalog #: 2944RT

**APPLICATIONS**

For use in wet locations to bond and secure EMT conduit to a box or enclosure  
RACO Raintight Steel EMT Compression fittings have been designed to comply with the new U.L. Raintight test requirements and to comply with the requirements of the 2008 NEC 358.42 and 314.15

**PRODUCT FEATURES**

All steel construction insures mechanical protection for the raceway  
Fittings are available in 1/2 in. to 4 in. trade sizes  
Zinc electroplate finish  
All fittings are marked "Wet Locations" to allow inspecting authorities to immediately determine that the installation is up to code  
All connectors are supplied with a factory installed knockout seal. No need to add the expense of buying a gasket separately.  
No need to disassemble the fitting prior to installation. RACO Raintight Steel EMT Compression fittings are designed so that when they come out of the carton they can be installed directly on the conduit. No need to waste time loosing compression nuts.  
No need for special tools to install properly. Install these fittings like any other Steel EMT Compression fitting. No need for a torque wrench to insure proper installation.  
N/A

**CULUS**

Standard 514B, UL Listed E195970, C22.2 No. 18

**GENERAL PRODUCT INFORMATION**

Sub Class: Uninsulated  
Trade Size: 3-1/2 in.

**DRAWING DIMENSIONS**

Dimension A: 2.81 in.  
Dimension B: 1.00 in.  
Dimension C: 4.68 in.

**PACKAGING**

Package Type: Carton  
Ship Carton Qty.: 1  
Product UPC-A Labeled: No  
Weight (Lbs. Per/C): 287.30  
Ship Carton Length (in.): 6.25  
Ship Carton Width (in.): 6.25  
Ship Carton Height (in.): 5.00  
Ctn Weight (Lbs.): 2.87  
UPC Number: 050169501023  
I2of5: 50050169501028