

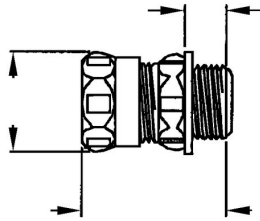

## EMT COMPRESSION CONNECTORS

Compression Connectors, Steel

B05



Catalog #: 2964US

### APPLICATIONS

For use to bond EMT conduit to a box or enclosure.  
RACO Compression connectors are suitable for applications above 600V.

### PRODUCT FEATURES

1/2 in. to 4 in. connectors provide concrete-tight connections  
All steel construction ensures mechanical protection for the raceway  
All components are zinc electroplated for corrosion protection  
UPC bar coded fittings are individually polybagged with a preprinted UPC-A bar code, and packaged in pre-scored tear top cartons for an attractive presentation.

### CULUS

Standard 514B, UL Listed E195970, C22.2 No. 1

### COMPLIANCES

MSDS  
[www.hubbell-rtb.com/certifications/Hubbell-RACO\\_MSDS\\_for\\_WP\\_Boxes\\_and\\_Fittings,January\\_2015.pdf](http://www.hubbell-rtb.com/certifications/Hubbell-RACO_MSDS_for_WP_Boxes_and_Fittings,January_2015.pdf)

### GENERAL PRODUCT INFORMATION

Sub Class: Insulated  
Trade Size: 3-1/2 in.

### DRAWING DIMENSIONS

Dimension A: 2.81 in.  
Dimension B: 1.00 in.  
Dimension C: 4.68 in.

### PACKAGING

Package Type: Carton  
Ship Carton Qty.: 1  
Product UPC-A Labeled: No  
Weight (Lbs. Per/C): 390.00  
Ship Carton Length (in.): 5.75  
Ship Carton Width (in.): 5.75  
Ship Carton Height (in.): 4.75  
Ctn Weight (Lbs.): 3.00  
UPC Number: 050169570586  
I2of5: 50050169570581