

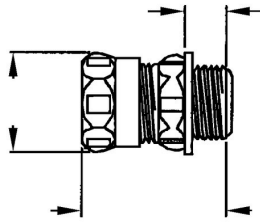

## EMT RAINTIGHT COMPRESSION CONNECTORS

Compression Connectors, Raintight Steel  
N/A

B07



Catalog #: 2966RT

### APPLICATIONS

For use in wet locations to bond and secure EMT conduit to a box or enclosure

RACO Raintight Steel EMT Compression fittings have been designed to comply with the new U.L. Raintight test requirements and to comply with the requirements of the 2008 NEC 358.42 and 314.15

### PRODUCT FEATURES

All steel construction insures mechanical protection for the raceway

Fittings are available in 1/2 in. to 4 in. trade sizes

Zinc electroplate finish

All fittings are marked "Wet Locations" to allow inspecting authorities to immediately determine that the installation is up to code

All connectors are supplied with a factory installed knockout seal. No need to add the expense of buying a gasket separately.

No need to disassemble the fitting prior to installation. RACO Raintight Steel EMT Compression fittings are designed so that when they come out of the carton they can be installed directly on the conduit. No need to waste time loosing compression nuts.

No need for special tools to install properly. Install these fittings like any other Steel EMT Compression fitting. No need for a torque wrench to insure proper installation.

N/A

### CULUS

Standard 514B, UL Listed E195970, C22.2 No. 18

### GENERAL PRODUCT INFORMATION

Sub Class: Insulated  
Trade Size: 4 in.

### DRAWING DIMENSIONS

Dimension A: 2.81 in.  
Dimension B: 1.00 in.  
Dimension C: 5.18 in.

### PACKAGING

Package Type: Carton  
Ship Carton Qty.: 1  
Product UPC-A Labeled: No  
Weight (Lbs. Per/C): 342.60  
Ship Carton Length (in.): 6.25  
Ship Carton Width (in.): 6.25  
Ship Carton Height (in.): 5.00  
Ctn Weight (Lbs.): 1.77  
UPC Number: 050169501078  
I2of5: 50050169501073