

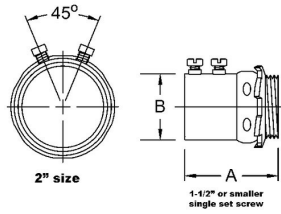

## RIGID SET SCREW CONNECTORS - STEEL

Set Screw Connector, Steel

B24



Catalog #: 3006

### APPLICATIONS

For use in dry locations to bond unthreaded rigid/IMC conduit to a box or enclosure. RACO steel set screw connectors provide concrete-tight connections when taped.

### PRODUCT FEATURES

All steel construction ensures mechanical protection for the raceway  
All components are zinc electroplated for corrosion protection

### UL LISTED

Standard 514B, UL Listed E195969

### COMPLIANCES

MSDS  
[www.hubbell-rtb.com/certifications/Hubbell-RACO\\_MSDS\\_for\\_WP\\_Boxes\\_and\\_Fittings\\_January\\_2015.pdf](http://www.hubbell-rtb.com/certifications/Hubbell-RACO_MSDS_for_WP_Boxes_and_Fittings_January_2015.pdf)

### GENERAL PRODUCT INFORMATION

Sub Class: Uninsulated  
Trade Size: 1-1/2 in.

### DRAWING DIMENSIONS

Dimension A: 1-7/8 in.  
Dimension B: 2-1/4 in.  
Thread Spec. B: 1-1/2 in. - 11-1/2 NPS

### PACKAGING

Package Type: Carton  
Ship Carton Qty.: 5  
Product UPC-A Labeled: No  
Weight (Lbs. Per/C): 80.50  
Ship Carton Length (in.): 6.25  
Ship Carton Width (in.): 4.50  
Ship Carton Height (in.): 4.25  
Ctn Weight (Lbs.): 4.03  
UPC Number: 050169030066  
I2of5: 50050169030061