

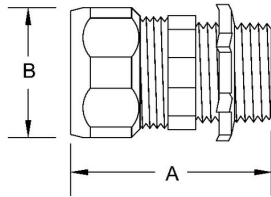

RIGID COMPRESSION CONNECTORS - STEEL/MALLEABLE IRON

Compression Connectors Steel/Malleable Iron
N/A

B26



Catalog #: 3804RAC

APPLICATIONS

For use to bond unthreaded rigid/IMC conduit to a box or enclosure
RACO 1/2 in. to 4 in. connectors and couplings provide concrete-tight connections

PRODUCT FEATURES

All steel/malleable construction insures mechanical protection for the raceway
Hex compression nuts assure easy wrench installation
All components are zinc electro plated for corrosion protection
N/A

UL LISTED

Standard 514B, UL Listed E195969

CSA

C22.2 No. 18

GENERAL PRODUCT INFORMATION

Sub Class: Insulated
Trade Size: 1 in.

DRAWING DIMENSIONS

Dimension A: 1-37/64 in.
Dimension B: 1-3/4 in.
Thread Spec. B: 1 in. - 11-1/2 NPS

PACKAGING

Package Type: Carton
Ship Carton Qty.: 10
Product UPC-A Labeled: No
Weight (Lbs. Per/C): 45.90
Ship Carton Length (in.): 6.81
Ship Carton Width (in.): 4.56
Ship Carton Height (in.): 4.13
Ctn Weight (Lbs.): 4.79
UPC Number: 050169538043
I2of5: 50050169538048