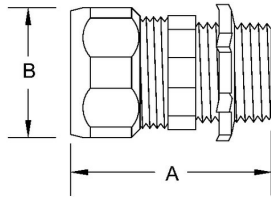

**RIGID COMPRESSION CONNECTORS - STEEL/MALLEABLE IRON**

Compression Connectors Steel/Malleable Iron
N/A

B26

Catalog #: 3805RAC

APPLICATIONS

For use to bond unthreaded rigid/IMC conduit to a box or enclosure
RACO 1/2 in. to 4 in. connectors and couplings provide concrete-tight connections

PRODUCT FEATURES

All steel/malleable construction insures mechanical protection for the raceway
Hex compression nuts assure easy wrench installation
All components are zinc electro plated for corrosion protection
N/A

UL LISTED

Standard 514B, UL Listed E195969

CSA

C22.2 No. 18

GENERAL PRODUCT INFORMATION

Sub Class: Insulated
Trade Size: 1-1/4 in.

DRAWING DIMENSIONS

Dimension A: 1-55/64 in.
Dimension B: 2-5/32 in.
Thread Spec. B: 1-1/4 in. - 11-1/2 NPS

PACKAGING

Package Type: Carton
Ship Carton Qty.: 5
Product UPC-A Labeled: No
Weight (Lbs. Per/C): 85.30
Ship Carton Length (in.): 8.75
Ship Carton Width (in.): 5.00
Ship Carton Height (in.): 3.88
Ctn Weight (Lbs.): 4.54
UPC Number: 050169538050
I2of5: 50050169538055