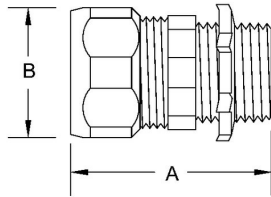

**RIGID COMPRESSION CONNECTORS - STEEL/MALLEABLE IRON****Compression Connectors Steel/Malleable Iron**  
N/A**B26**

Catalog #: 3808RAC

**APPLICATIONS**

For use to bond unthreaded rigid/IMC conduit to a box or enclosure  
RACO 1/2 in. to 4 in. connectors and couplings provide concrete-tight connections

**PRODUCT FEATURES**

All steel/malleable construction insures mechanical protection for the raceway  
Hex compression nuts assure easy wrench installation  
All components are zinc electro plated for corrosion protection  
N/A

**UL LISTED**

Standard 514B, UL Listed E195969

**CSA**

C22.2 No. 18

**GENERAL PRODUCT INFORMATION**

Sub Class: Insulated  
Trade Size: 2 in.

**DRAWING DIMENSIONS**

Dimension A: 2-7/32 in.  
Dimension B: 2-7/8 in.  
Thread Spec. B: 2 in. - 11-1/2 NPS

**PACKAGING**

Package Type: Carton  
Ship Carton Qty.: 5  
Product UPC-A Labeled: No  
Weight (Lbs. Per/C): 129.00  
Ship Carton Length (in.): 8.65  
Ship Carton Width (in.): 6.31  
Ship Carton Height (in.): 3.50  
Ctn Weight (Lbs.): 6.76  
UPC Number: 050169538081  
I2of5: 50050169538086