

ALM2

by CMC
Catalog ID: ALM2

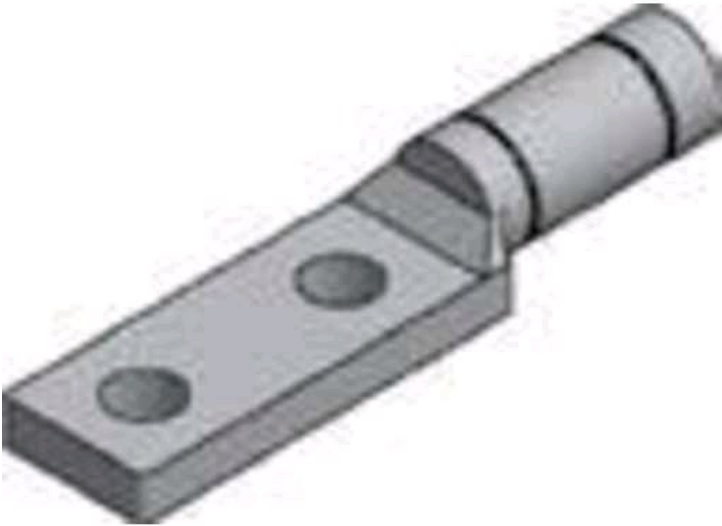

Aluminum Two-Hole, NEMA-Drilled Compression Terminal Lugs

- Standard mounting hole diameter is .562" for 1/2" bolts
- The end wall within the cable socket of this design is solid and pressure tight
- Connectors are pre-filled and plugged with electrical joint compound
- Marked with catalog number, conductor size and die reference
- Meets performance requirements of ANSI C119.4
- Material: Aluminum

Product Details

General

Material	Aluminum
Number of Holes	2
UPC	192663118434

Dimensions

Height	0.56 in
Length	5.75 in
Thickness	0.25 in
Width	1 in