

ALM500-1

by CMC
Catalog ID: ALM500-1

Aluminum Two-Hole, NEMA-Drilled Compression
Terminal Lugs

- Standard mounting hole diameter is .562" for 1/2" bolts
- The end wall within the cable socket of this design is solid and pressure tight
- Connectors are pre-filled and plugged with electrical joint compound
- Marked with catalog number, conductor size and die reference
- Meets performance requirements of ANSI C119.4
- Material: Aluminum

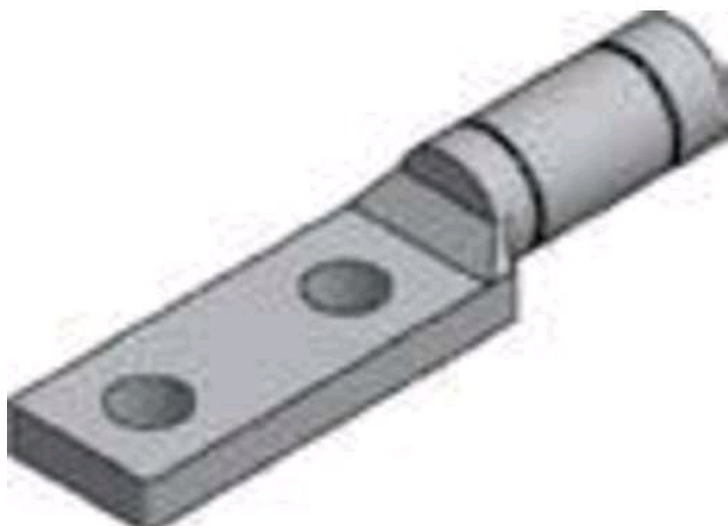

Product Details

General

Material	Aluminum
Number of Holes	2
UPC	192663118618

Dimensions

Height	0.56 in
Length	6.88 in
Thickness	0.41 in
Width	1.32 in

CONNECTOR MANUFACTURING COMPANY

3501 Symmes Road

Hamilton, Ohio 45015 - 1369

513 - 860 - 4455(Press 2 for Customer Service and Sales)

To email customer Service: jrex@cmclugs.com