

## Suspension Clamp

By ANDERSON  
Catalog # CFST2130S

The CFST2 suspension clamp is a double groove, saddle type suspension clamp designed for use on standard or extra-high voltage T2 transmission lines. Type CFST2 is recommended for AAC, ACSR, or AAAC T2 conductors. Maximum conductor temperature 130°C. Corona and RIV are controlled through the design of the clamp, thus eliminating the need for additional corona suppression. U-bolts are retained in place by grommets. Conductor clamping range is 0.88-1.30 inches. Ultimate body strength is 25,000 lbs.

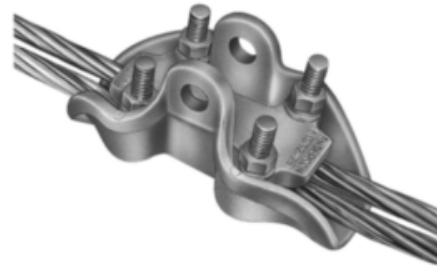

\*Representative Image

### Features

- Bolt and nut may be substituted for clevis pin by adding suffix "BNK" to catalog number.
- The clevis bolt and clevis pin are the same diameter.
- "S" suffix indicates the suspension clamp will contain the socket eye SA22.

### General

Bolt Installation Torque (Recommended)	480 in-lbs
EU RoHS Indicator	No
Fitting Type	Socket
Material - Clamp	Aluminum
Material - Hardware	Galvanized Steel
Material - Pin	Stainless Steel
Material - Pin (Cotter)	Stainless Steel
Material - Socket and Clevis	Galvanized Ductile Iron
Product Category	Suspension Clamp
Strength Rating - Ultimate Body	25000 lb
Type	EHV/T2 Suspension Clamps
U-Bolts	1/2 in
UPC	096359386087

### Dimensions

Angle - Take-Off Maximum	17.5 °
Clamping - Maximum	1.3 in
Clamping - Minimum	0.88 in
Clevis Opening	3 in
Diameter - Clevis Pin	0.625 in
Height	3.0 in
Length	10.5 in
Weight	7.900 lb

### Electrical Ratings

Voltage Application	EHV
---------------------	-----

### Conductor Related

Clamping Range	0.88- 1.3
Conductor Compatibility	ACSR-Penguin-4/0-6/1;ACSR-Waxwing-266.8-18/1;ACSR-Partridge-266.8-26/7;ACSR-Ostrich-300-26/7;ACSR-Merlin-336.4-18/1;ACSR-Linnet-336.4-26/7;ACSR-Oriole-336.4-30/7;ACSR-Chickadee-397.5-18/1;ACSR-Brant-397.5-24/7;ACSR-Ibis-397.5-26/7;ACSR-Hen-477-30/7;ACSR-Parakeet-556.5-24/7;ACSR-Dove-556.5-26/7;ACSR-Eagle-556.5-30/7;ACSR-Peacock-605-24/7;ACSR-Squab-605-26/7;ACSR-Teal-605-30/19;ACSR-Kingbird-636-18/1;ACSR-Swift-636-36/1;ACSR-Rook-636-24/7;ACSR-Grosbeak-636-26/7;ACSR-Egret-636-30/19;ACSR-Flamingo-666.6-24/7;ACSR-Gannet-666.6-26/7;ACSR-Stilt-715.5-24/7;ACSR-Starling-715.5-26/7;ACSR-Redwing-715.5-30/19;ACSR-Coot-795-36/1;ACSR-Cuckoo-795-24/7;ACSR-Drake-795-26/7;ACSR-Tern-795-45/7;ACSR-Condor-795-54/7;ACSR-Mallard-795-30/19;ACSR-Ruddy-900-45/7;ACSR-Canary-900-54/7;ACSR-Rail-954-45/7;ACSR-Cardinal-954-54/7;ACSR-Ortolan-1033.5-45/7;ACSR-Curlew-1033.5-54/7;ACSR-Bluejay-1113-45/7;ACSR-Finch-1113-54/19;ACSR-Brahma-203.2-16/19;AAC-Valerian-250-19;AAC-Laurel-266.8-19;AAC-Daffodil-350-19;AAC-Canna-397.5-19;AAC-Cosmos-477-19;AAC-Syringa-477-37;AAC-Meadowsweet-600-37;AAC-Orchid-636-37;AAC-Flag-700-61;AAC-Violet-715.5-37;AAC-Nasturtium-715.5-61;AAC-

Cattail-750-61;AAC-Arbutus-795-37;AAC-Lilac-795-61;AAC-Cockscomb-900-37;AAC-Snapdragon-900-61;AAC-Magnolia-954-37;AAC-Goldenrod-954-61;AAC-Camellia-1000-61;AAC-Bluebell-1033.5-37;AAC-Larkspur-1033.5-61;AAC-Marigold-1113-61;AAC-Hawthorn-1192.5-61;AAC-Narcissus-1272-61;AAAC 6201 Alloy-Alliance-246.9-6/18;ACAR-653.1-12/7;ACAR-739.8-18/19;ACAR-853.7-30/7;ACAR-1024.5-30/7;ACAR-1109-30/7;ACAR-1172-30/7;ACAR-1172-18/19

## Product Assets

[Catalogs - Transmission Connectors Catalog - Full \(CA05063E\)](#)

[Literature - Ropes Course Industry Letter \(April 2021\)](#)



A proud member of the Hubbell Family.

©2024 Hubbell Incorporated. All rights reserved.  
AN-CFST2130S-SPEC-EN | REV 1/2024