

Suspension Clamp

By ANDERSON
Catalog # [CFST288S](#)

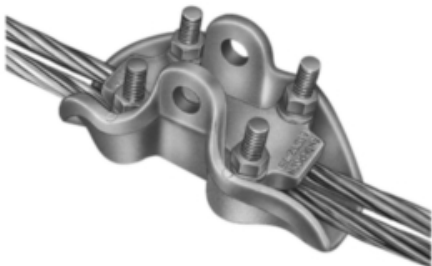

Type CFST2 is recommended for AAC, ACSR or AAAC T2 conductors. Maximum conductor temperature 130 C. See Catalog Reference section for maximum conductor temperature guidelines. Designed with double grooves for use on standard or extra-high voltage T2 transmission lines. Corona and RIV are controlled through the design of the clamp, thus eliminating the need for control rings. U-bolts are retained in place by grommets. Material: clamp body - aluminum alloy, hardware - galvanized steel, socket and clevis - galvanized ductile iron, cotter pin - stainless steel, grommet - neoprene.

Features

Corona and RIV are controlled through the design of the clamp, thus eliminating the need for control rings.

General

Bolt Installation Torque (Recommended)	480 in-lbs
EU RoHS Indicator	No
Fitting Type	Socket
Material - Clamp	Aluminum
Material - Hardware	Galvanized Steel
Material - Pin (Cotter)	Stainless Steel
Material - Socket and Clevis	Galvanized Ductile Iron
Product Category	Suspension Clamp
Strength Rating - Ultimate Body	20000 lb
Type	EHV/T2 Suspension Clamps
U-Bolts	1/2 in
UPC	096359403463

Dimensions

Angle - Take-Off Maximum	17.5 °
Clamping - Maximum	0.88 in
Clamping - Minimum	0.75 in
Clevis Opening	2 in
Diameter - Clevis Pin	0.625 in
Height	2.5 in
Length	8.44 in
Weight	4.3 lb

Electrical Ratings

Voltage Application	EHV
---------------------	-----

Conductor Related

Clamping Range	0.75- 0.88
----------------	------------

Product Assets

[Catalogs - Transmission Connectors Catalog - Full \(CA05063E\)](#)
[Literature - Ropes Course Industry Letter \(April 2021\)](#)

