

## Stud Connector, Bronze

By ANDERSON  
Catalog # [HDSF061216](#)

"Bolted Stud Connectors, Bronze Stud To Flat Bar, Stud Dia./Thd.- 1-1/4"-12, Flat Bar width-4", Material: Casting-Bronze Alloy, Hardware-Silicon Bronze or Stainless Steel"

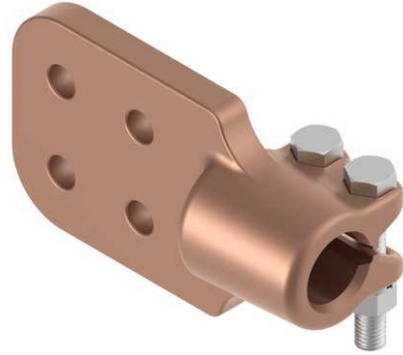

\*Representative Image

### Features

- "To specify 90 degree connector, add "90" to catalog number. Example: HDSF06129016"

### General

EU RoHS Indicator	No
Material	Bronze
Material - Clamping Hardware	Stainless Steel
Number of Pad Holes	2
Number of Stud Threads	16
Type	Stud to Flat
UPC	096359315582

### Dimensions

Angle - Stud to Pad	180 °
Diameter - Stud	3.75 in
Weight	2.058 lb
Width - Pad	2 in

### Product Assets

- [Catalogs - Substation Connectors \(SA\)](#)
- [Sales Drawings - CC-5850 \(HDSF Product Family\)](#)
- [Technical Solutions - AN-HDSF061216-SPEC-EN](#)
- [Video - Hubbell Power Systems 3D Portal to help with developing 3D models of substation connector products \(VI05050E0619\)](#)
- [Video - Hubbell Power Systems Quick Ship \(VI05124E1018\)](#)