

Stud Connector, Bronze

By ANDERSON
Catalog # [HDSF141D1212TP](#)

"Bolted Stud Connectors, Bronze Stud To Flat Bar, Stud Dia./Thd.-3"-12, Flat Bar width-4", Material: Casting-Bronze Alloy, Hardware-Silicon Bronze or Stainless Steel"

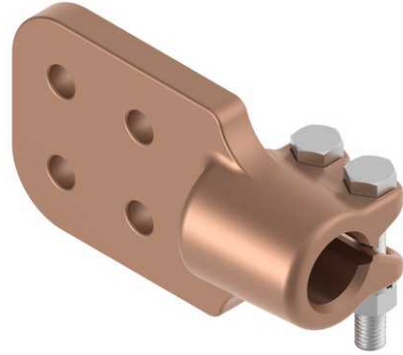

*Representative Image

Features

- "To specify 90 degree connector, add "90" to catalog number. Example: HDSF141D129012TP"

General

Material	Bronze
Material - Clamping Hardware	Stainless Steel
Number of Pad Holes	4
Number of Stud Threads	12
Type	Studs
UPC	096359315940

Dimensions

Angle - Stud to Pad	180 °
Diameter - Stud	1.5 in
Dimensions	4 in x 7 in x 0.5 in
Height	0.5 in
Length	4 in
Weight	5.196 lb
Width	7 in
Width - Pad	4 in

Logistics

Pallet Quantity	252
-----------------	-----

Product Assets

[Catalogs - Substation Connectors \(SA\)](#)

[Sales Drawings - CC-12926](#)

[Technical Solutions - AN-HDSF141D1212TP-SPEC-EN](#)

[Video - Hubbell Power Systems 3D Portal to help with developing 3D models of substation connector products \(VI05050E0619\)](#)

[Video - Hubbell Power Systems Quick Ship \(VI05124E1018\)](#)