

## Stud Connector, Bronze

By ANDERSON  
Catalog # [HDSF1613129012](#)

"Bolted Stud Connectors, Bronze Stud To Flat Bar, Stud Dia./Thd.-4"-12, Flat Bar width-4", Material: Casting-Bronze Alloy, Hardware-Silicon Bronze or Stainless Steel"

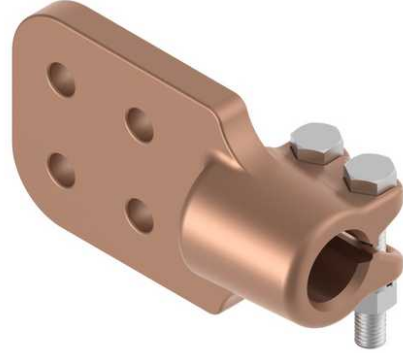

\*Representative Image

### Features

- 0

### General

Material	Bronze
Material - Clamping Hardware	Stainless Steel
Number of Pad Holes	4
Number of Stud Threads	12
Type	Stud to Flat

### Dimensions

Angle - Stud to Pad	90 °
Diameter - Stud	1.75 in
Weight	5.900 lb
Width - Pad	3 in

### Product Assets

- [Catalogs - Substation Connectors \(SA\)](#)
- [Technical Solutions - AN-HDSF1613129012-SPEC-EN](#)
- [Video - Hubbell Power Systems 3D Portal to help with developing 3D models of substation connector products \(VI05050E0619\)](#)
- [Video - Hubbell Power Systems Quick Ship \(VI05124E1018\)](#)