

Stud Connector, Bronze

By ANDERSON
Catalog # [HDSF321D349012](#)

"Tin Plated Bolted Stud Connectors, Bronze Stud To Flat Bar, Stud Dia./Thd.-1-1/2"-14, Flat Bar width-4", Material: Casting-Bronze Alloy, Hardware-Silicon Bronze or Stainless Steel"

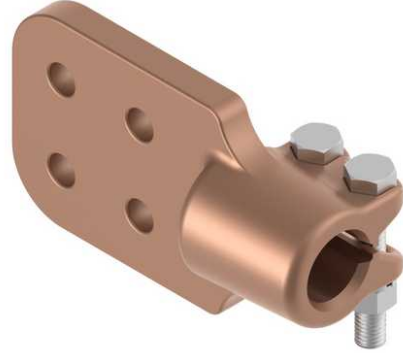

*Representative Image

Features

- 0

General

Material	Bronze
Material - Clamping Hardware	Stainless Steel
Number of Pad Holes	4
Number of Stud Threads	12
Type	Stud to Flat

Dimensions

Angle - Stud to Pad	90 °
Diameter - Stud	3.25 in
Weight	14.200 lb
Width - Pad	4 in

Product Assets

- [Catalogs - Substation Connectors \(SA\)](#)
- [Technical Solutions - AN-HDSF321D349012-SPEC-EN](#)
- [Video - Hubbell Power Systems 3D Portal to help with developing 3D models of substation connector products \(VI05050E0619\)](#)
- [Video - Hubbell Power Systems Quick Ship \(VI05124E1018\)](#)