

Stud Connector, Bronze

By ANDERSON
Catalog # [HDSF401D112](#)

"Bolted Stud Connectors, Bronze Stud To Flat Bar, Stud Dia./Thd.-1-1/2"-12, Flat Bar width-4", Material: Casting-Bronze Alloy, Hardware-Silicon Bronze or Stainless Steel"

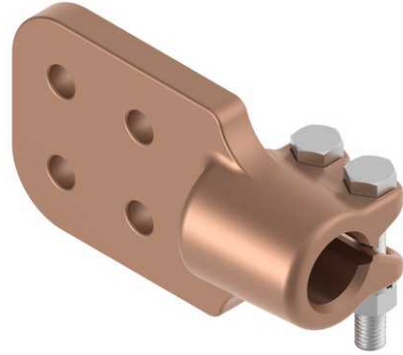

*Representative Image

Features

- "To specify 90 degree connector, add "90" to catalog number. Example: HDSF401D19012"

General

EU RoHS Indicator	No
Material	Bronze
Material - Clamping Hardware	Stainless Steel
Number of Pad Holes	4
Number of Stud Threads	12
Type	Studs
UPC	096359316244

Dimensions

Angle - Stud to Pad	180 °
Diameter - Stud	4 in
Weight	6.537 lb
Width - Pad	4 in

Logistics

Pallet Quantity	80
-----------------	----

Product Assets

- [Catalogs - Substation Connectors \(SA\)](#)
- [Sales Drawings - CC-5850 \(HDSF Product Family\)](#)
- [Technical Solutions - AN-HDSF401D112-SPEC-EN](#)
- [Video - Hubbell Power Systems 3D Portal to help with developing 3D models of substation connector products \(VI05050E0619\)](#)
- [Video - Hubbell Power Systems Quick Ship \(VI05124E1018\)](#)