

## Terminal, Bronze Bolted

By ANDERSON  
Catalog # [STF406B2](#)

"Terminal, Bolted, Tube to Flat, 4-hole Pad, Straight, Center formed, Conductor size tubing IPS: 2 1/2", Material: Castings-Bronze alloy, Clamping hardware-Stainless steel"

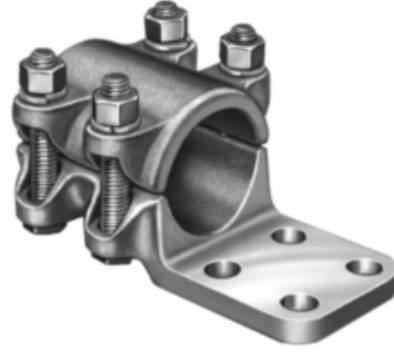

\*Representative Image

### Features

- "Centre formed pads may be obtained by adding suffix-CF to the catalog number
- 45° & 90° angle connectors may be obtained by specifying desired angle
- For Suffix "ED" Everdur (silicon bronze) hardware will be supplied instead of the usual hardware
- For "TP" suffix Tin plating will be supplied on bronze items
- For suffix "XY" Contact surface finished on both sides of tongue"

### General

Material	Bronze
Material - Clamping Hardware	Stainless Steel
Number of Bolt Holes	2
Number of Pad Holes	2
Type	Terminal, Bronze Bolted
UPC	096359326328

### Dimensions

Angle - Pad	180 °
Weight	3.528 lb
Width - Pad	2 in

### Conductor Related

Conductor Type	Copper Bus
----------------	------------

### Logistics

Pallet Quantity	420
-----------------	-----

### Product Assets

[Catalogs - Substation Connectors \(SA\)](#)

[Video - Hubbell Power Systems 3D Portal to help with developing 3D models of substation connector products \(VI05050E0619\)](#)

[Video - Hubbell Power Systems Quick Ship \(VI05124E1018\)](#)