

## Terminal, Bronze Bolted

By ANDERSON  
Catalog # [STF414CCF](#)

" Tin-plated Bolted Terminal, Cable to Flat, 2-hole Pad, Straight, Conductor Range: 0.204"- 0.575 ", Material: Castings- Bronze alloy, Hardware- Silicon Bronze or Stainless Steel"

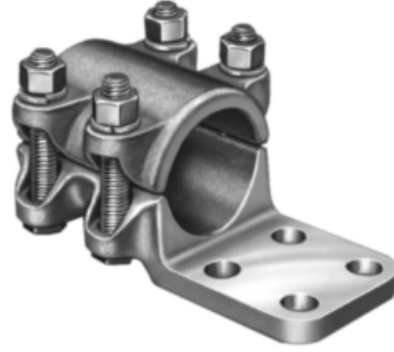

\*Representative Image

### Features

- "45° & 90° angle connectors may be obtained by specifying desired angle
- For Suffix "ED" Everdur (silicon bronze) hardware will be supplied instead of the usual hardware
- For "TP" suffix Tin plating will be supplied on bronze items
- For suffix "XY" Contact surface finished on both sides of tongue"

### General

|                              |                         |
|------------------------------|-------------------------|
| EU RoHS Indicator            | No                      |
| Material                     | Bronze                  |
| Material - Clamping Hardware | Stainless Steel         |
| Number of Pad Holes          | 4                       |
| Type                         | Terminal, Bronze Bolted |
| UPC                          | 096359326625            |

### Dimensions

|             |          |
|-------------|----------|
| Angle - Pad | 180 °    |
| Weight      | 4.998 lb |
| Width - Pad | 3 in     |

### Conductor Related

|                |            |
|----------------|------------|
| Conductor Type | Copper Bus |
|----------------|------------|

### Product Assets

- [Catalogs - Substation Connectors \(SA\)](#)
- [Sales Drawings - C019844-00 \(STF Product Family\)](#)
- [Video - Hubbell Power Systems 3D Portal to help with developing 3D models of substation connector products \(VI05050E0619\)](#)
- [Video - Hubbell Power Systems Quick Ship \(VI05124E1018\)](#)