

Tee, Bronze Bolted

By ANDERSON
Catalog # [TT2C24050](#)

"Bolted Tees, Connecting Tubing Main to Cable Tap, Tubing Main-IPS-1", Cable Tap- 1/0 Sol.-500 MCM, Cable Dia.-0.325"-0.813", Material: Castings- Bronze Alloy, Hardware- Silicon Bronze or Stainless Steel"

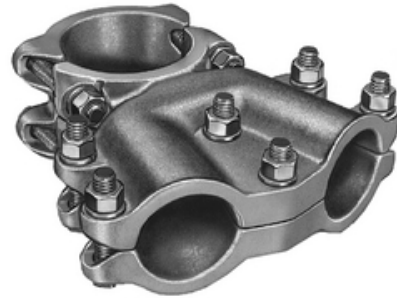

*Representative Image

Features

- "Tee for Connecting Copper Tubing Main to Copper Cable Tap
- All cable taps furnished with reversible cable caps"

General

| | |
|----------------------------------|-----------------|
| EU RoHS Indicator | No |
| Material | Bronze |
| Material - Clamping Hardware | Stainless Steel |
| Number of Ground Braid Lug Holes | 0 |
| Type | Bolted Tees |
| UPC | 096359332466 |

Dimensions

| | |
|---------------------------|----------|
| Base Hole Spacing | 0 in |
| Diameter - Base Holes | 0 in |
| Diameter - Bolt | 0 in |
| Diameter - Inside | 0 in |
| Length - Coupling | 0 in |
| Length Before Compression | 0 in |
| Weight | 8.820 lb |

Electrical Ratings

| | |
|---|---|
| Maximum Current Rating Amps Continuous | 0 |
|---|---|

Conductor Related

| | |
|---------------------------------------|---|
| Conductor Diameter (Tap) - Maximum | 0.813 in |
| Conductor Diameter (Tap) - Minimum | 0.325 in |
| Conductor Type | <ul style="list-style-type: none">• Copper Bus• Copper |

Product Assets

[Catalogs - Substation Connectors \(SA\)](#)

[Sales Drawings - C-4172 \(TT2C Product Family\)](#)

[Video - Hubbell Power Systems 3D Portal to help with developing 3D models of substation connector products \(VI05050E0619\)](#)

[Video - Hubbell Power Systems Quick Ship \(VI05124E1018\)](#)