

HUBBELL Power Systems

Y-Clevis Eye, Rotated

By ANDERSON

Catalog # [YCS219013](#)

Y-clevis eyes are primarily used to attach clamping devices to yoke plates or other associated hardware in a bundle conductor assembly. The bent bolt in the Y-section provides an additional point of articulation within an assembly. Material: body - galvanized steel, hardware - galvanized steel.

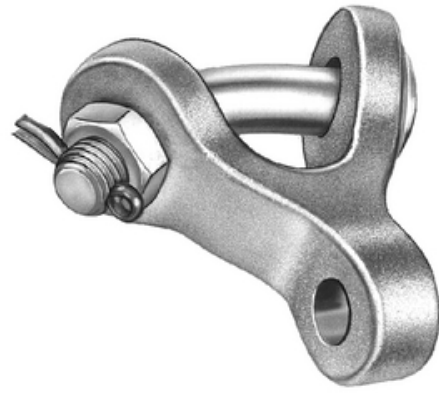

*Representative Image

Features

Bent bolt in Y-section provides an additional port of articulation within an assembly, Material: Body-Galvanized Ductile Iron, Hardware-Galvanized Steel, Cotter Pin-Stainless Steel

General

EU RoHS Indicator	No
Material	Ductile Iron
Material - Pin (Clevis)	Galvanized Steel
Material - Pin (Cotter)	Stainless Steel
Number of Bolt Holes	0
Series	YCS-90 Series
Strength Rating - Ultimate	30000 lb
Strength Rating - Ultimate Body	0 lb
UPC	096359344704

Dimensions

Assembly Rating (Ultimate)	0 lb
Diameter - Bolt	0 in
Diameter - Eye Hole	0.813 in
Diameter - Pin	0 in
Insulator Throat Diameter - Maximum	0 in
Insulator Throat Diameter - Minimum	0 in
Insulator Throat Diameter Range	0 - 0
Length - Coupling	2.438 in
Length - Pin	0 in
Maximum Adjustment	0 in
Ring Height	0 in
Weight	2.94 lb
Width - Eye	2.125 in

Conductor Related

Conductor Diameter - Maximum	0 in
Conductor Spacing	0 in

Logistics

Pallet Quantity 720

Product Assets

[Catalogs - Transmission Connectors Catalog - Full](#)

