

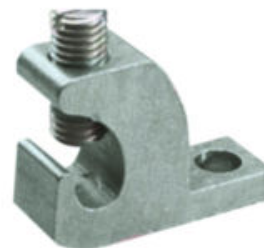

CL250516TN, Copper Lay-in Lug, Tin Plated

By Burndy
Catalog # [CL250516TN](#)



COPPER LAY-IN-LUG WIRE RANGE: 250 kcmil - #6 STEEL SET SCREW TIN PLATED.

Features

- UL486A-B Wire Connectors
- CSA Certified
- Suitable for copper conductors only

General

Catalog Number	CL250516TN
Plated	Y
Plating Type	Tin
Trade Name	QIKLUG™
UPC	781810505168
UPC 12 Digit	7818105051688

Dimensions

Dimension - Height inch	1.79 in
Dimension - Hole Size inch	0.33 in
Dimension - Length Overall inch	2.20 in
Dimension - Pad Width inch	0.80 in
Dimension - Width inch	0.80 in

Conductor Related

Conductor - Copper Solid Size	6 AWG;5 AWG;4 AWG;3 AWG;2 AWG;1 AWG;1/0 AWG;2/0 AWG;3/0 AWG;4/0 AWG
Conductor - Copper Solid Size Range	6 AWG-4/0 AWG
Conductor - Copper Str Size	6 AWG;5 AWG;4 AWG;3 AWG;2 AWG;1 AWG;1/0 ;2/0 AWG;3/0 AWG;4/0 AWG;250 kcmil
Conductor - Copper Str Size Range	6 AWG - 250 kcmil

Certifications And Compliance

Certification - CSA Approved	No
Certification - ETL	No
Certification - UL Recognized	No
Certification - cULus	No
Standards - RoHS Compliance Status	CM
UL Listed	Yes

Logistics

Carton Quantity	70
Minimum Pack Quantity	1

Product Assets

[Catalogs - BURNDY Master Catalog - Full Line BURNDY Catalog](#)
[Catalogs - BURNDY Master Catalog - Section A - Mechanical](#)
[Interactive Catalog - BURNDY Full-Line Digital Catalog](#)
[Product Cross Section Image\(s\) - BUR_CL_LA](#)
[Sales Drawings - 30000650](#)
[Specifications - CL250516TN](#)