

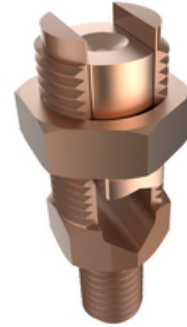

K2C25B1, SERVIT POST Mechanical Connector, 2 Cables to Flat

By Burndy
Catalog # [K2C25B1](#)

Mechanical Grounding Connector, Cable to Flat, 2-1/0 AWG (Str) / 2-2/0 AWG (Sol), 1/2" Stud.



Application

For Used To Ground One Or Two Copper Cables To Steel Structures, Fence Posts, Transformers, Tap One Or Two Cables From Bus Bar And Direct Burial

General

EU RoHS Indicator	Yes
Material	Bronze Alloy, Leaded
Plated	N
Plating Type	Unplated
Stud Installation Torque inch pounds	480 LBS/in
Sub Brand	SERVIT POST
Trade Name	SERVIT POST™
Type	KC and K2C Series
UPC	781810257357
UPC 12 Digit	7818102573577

Dimensions

Dimension - B Length fraction	1-1/16 in
Dimension - B Length inch	1.04 in
Dimension - Body Width inch	0.75 in
Dimension - Bolt Size fraction	1/2
Dimension - D inch	1.25 in
Dimension - Height fraction	1-1/8
Dimension - Height inch	1.19 in
Dimension - L Length Overall mm	71 mm
Dimension - Length Overall inch	2.81 in
Dimension - Nut Width inch	0.93 in
Dimension - P inch	0.39 in
Dimension - Threads per inch	13

Conductor Related

Conductor - Copper Solid Size	2 AWG;1 AWG;1/0 AWG;2/0 AWG
Conductor - Copper Solid Size Range	2 AWG-2/0 AWG
Conductor - Copper Str Size	2 AWG;1 AWG;1/0 AWG
Conductor - Copper Str Size Range	2 AWG-1/0 AWG
Physical Attribute - Number of Conductors Accommodated Total	2

Certifications And Compliance

Certification - CSA Approved	No
Certification - ETL	No
Certification - UL Listed Direct Burial	Yes
Certification - UL Recognized	No
Certification - cULus	No
Industry Standard(s)	UL467
Standards - Industry Standards Met	UL467
Standards - RoHS Compliance Status	EX
UL Listed	Yes

Logistics

Carton Quantity	25
Minimum Pack Quantity	1
Pallet Quantity	8700

Product Assets

[3D Models - K2C25B1_MODEL-PDF](#)
[3D Models - K2C25B1_MODEL-STEP](#)
[3D Models - K2C25B1_MODEL-IGES](#)
[Catalogs - Full Line BURNDY Catalog](#)
[Customer Notices - Prop 65 Notice](#)
[Product Cross Section Image\(s\) - BUR_K2C_Lineart](#)
[Sales Drawings - SD..055917](#)



A proud member of the Hubbell Family.

