

Substation - Copper Stud Connector

By Burndy
Catalog # [N11DR6844T12](#)

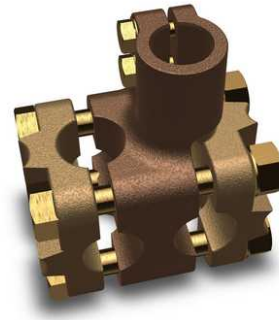

Copper Stud Connectors.

Application

Substation

General

Connector Type	Stud Connector
Material	Copper Alloy
Material - Hardware	DURIUM™ Silicon Bronze
Physical Attribute - Number of Tap Conductors	2
Plated	N
Plating Type	Unplated
Type	Studs
UPC	781810092903
UPC 12 Digit	7818100929033

Dimensions

Dimension - AA Pad Orientation	90 Degree; In-line
Dimension - B Length inch	2.03 in
Dimension - Height inch	5.00 in
Dimension - L Length Overall mm	155 mm
Dimension - Length Overall inch	6.12 in
Dimension - Pin Diameter fraction	2 in
Dimension - Pin Diameter inch	2.00 in
Dimension - Threads per inch	12

Conductor Related

Conductor - Connection Combination	Stud to Tube
Conductor - Copper Solid Size Range	2 AWG;1 AWG;1/0 AWG;2/0 AWG;3/0 AWG;4/0 AWG
Conductor - Copper Solid Size Range	2 AWG-4/0 AWG
Conductor - Copper Str Size Range	2 AWG;1 AWG;1/0 ;2/0 AWG;3/0 AWG;4/0 AWG;250 kcmil;300 kcmil;350 kcmil;400 kcmil;450 kcmil;500 kcmil;550 kcmil;600 kcmil;700 kcmil;750 kcmil;800 kcmil;850 kcmil;900 kcmil;1000 kcmil
Conductor - Copper Str Size Range	2 AWG-1000 kcmil
Conductor - Copper Tube Std Size	3/8 IPS IPS;1/2 IPS IPS;3/4 IPS IPS
Conductor - Copper Tube Std Size Range	3/8 IPS IPS-3/4 IPS IPS
Conductor Spacing	1.75 in

Certifications and Compliance

Certification - CSA Approved	No
Certification - ETL	No
Certification - UL Recognized	No
Certification - cULus	No
Standards - RoHS Compliance Status	EX
UL Listed	No

Logistics

Minimum Pack Quantity	2
-----------------------	---

Product Assets

[Customer Notices - Prop 65 Notice](#)
[Sales Drawings - sd037349](#)