

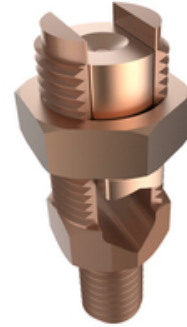

K2C25, SERVIT POST Mechanical Connector, 2 Cables to Flat

By Burndy
Catalog # [K2C25](#)

Mechanical Grounding Connector, Cable to Flat, 2-1/0 AWG (Str) / 2-2/0 AWG (Sol), Stud dia:1/2-13,1-1/8 H.



Application

For Direct Burial Applications And Used To Ground One Or Two Cables To Steel Structures, Fence Posts, Transformers, Also Used To Tap One Or Two Cables From Bus Bar

General

Catalog Number	K2C25
EU RoHS Indicator	Yes
Material	Bronze Alloy, Leaded
Plated	N
Plating Type	Unplated
Stud Installation Torque inch pounds	480 LBS/in
Sub Brand	SERVIT POST
Trade Name	SERVIT POST™
Type	KC and K2C Series
UPC	781810257302
UPC 12 Digit	7818102573022

Dimensions

Dimension - B Length fraction	9/16 in
Dimension - B Length inch	0.53 in
Dimension - Body Width inch	0.75 in
Dimension - Bolt Size fraction	1/2
Dimension - D inch	0.75 in
Dimension - Height fraction	1-1/8
Dimension - Height inch	1.56 in
Dimension - L Length Overall mm	62 mm
Dimension - Length Overall inch	2.44 in
Dimension - Nut Width inch	0.93 in
Dimension - P inch	0.39 in
Dimension - Threads per inch	13
Dimension - Width inch	40 mm

Conductor Related

Conductor - Copper Solid Size	2 AWG;1 AWG;1/0 AWG;2/0 AWG
Conductor - Copper Solid Size Range	2 AWG-2/0 AWG
Conductor - Copper Str Size	2 AWG;1 AWG;1/0 AWG
Conductor - Copper Str Size Range	1/0 AWG - 2 AWG
Physical Attribute - Number of Conductors Accommodated Total	2

Certifications And Compliance

Certification - CSA Approved	No
Certification - ETL	No
Certification - UL Listed Direct Burial	Yes
Certification - UL Recognized	No
Certification - cULus	No
Industry Standard(s)	UL467
Standards - Industry Standards Met	UL467
Standards - RoHS Compliance Status	EX
UL Listed	Yes

Logistics

Carton Quantity	25
Pallet Quantity	7425

Product Assets

[3D Models - K2C25_MODEL-IGES](#)
[3D Models - K2C25_MODEL-PDF](#)
[3D Models - K2C25_MODEL-STEP](#)
[Catalogs - Full Line BURNDY Catalog](#)
[Catalogs - Section E2 - Mechanical Grounding](#)
[Customer Notices - Prop 65 Notice](#)
[Product Cross Section Image\(s\) - BUR_K2C_Lineart](#)
[Sales Drawings - SD..055917](#)



A proud member of the Hubbell Family.

©2024 Hubbell Incorporated. All rights reserved.
BRDY_MX-K2C25-SPEC-EN | REV 6/2024

