

Straight Blade Devices

15A, 125V , 2-Pole 3-Wire

Bryant Hospital Grade •

Impact Resistant Connectors



Features

- Impact-resistant thermoplastic construction with automatic cord grip
- Transparent polycarbonate cover allows visual inspection of wire terminations without disassembly
- Pre-attached TPE (thermoplastic elastomer) dust seal helps prevent contaminants from entering wiring chamber

Ordering Information

Description	Cord Dia.	UPC Number	Catalog Number
NEMA 5-15, 15A 125V, Straight blade connector	.245"-.655" (6.2-16.6)	781786005983	BRY8269NC

Listings

UL Listed, CSA Certified, Complies with NEMA® Standards
WD-1 and WD-6, Listed to UL 498, Verified under Federal Specification WC596

Specifications

Cord Grip	Impact modified nylon
Cover (housing)	High-impact, V-O Valox®
Terminal cover	Clear polycarbonate
Dust seal	Thermoplastic elastomer
Connector contacts	High performance copper alloy
Terminal clamp nut	Zinc-plated steel
Terminal screws	#8-32 brass, silver finish on neutral screw, green finish on grounding screw
Assembly screws	Zinc-plated steel

Performance

Electrical	
Dielectric voltage	Withstands 1500V per UL498
Max. working voltage	250V AC or DC
Current interrupting	Certified for current interrupting at full rated current
Temperature rise	Max 30°C temperature rise at full rated current after 50 cycles of overload at 150% of rated direct current

Mechanical	
Product Identification	Terminals identified in accordance with UL 498 (brass, white, green)
Terminal Accommodation	#18-10 AWG flexible cord
Terminal Identification	Ratings and NEMA® identification are permanently marked on device
Cord accommodation	Round portable service cords in accordance with device ratings as defined in UL Standard 62, CSA C22.2 No. 49

Environmental	
Flammability	HB or better per UL 94
Operating Temperatures	Maximum continuous 60°C, minimum -40°C (without impact)

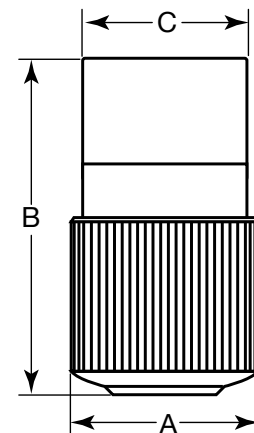

A	1.52" (38.6)
B	2.95" (74.9)
C	1.38" (35.1)

Online Resources

eCatalog

Dimensions in Inches (mm)

Bryant Electric • An affiliate of Hubbell Incorporated (Delaware) • 40 Waterview Drive • Shelton, CT 06484

Phone (800) 323-2792 • Specifications subject to change without notice