



B Beam Clamp

By Chance

Catalog # [PSC2080244](#)

B Beam Clamp used to deadend strand to I-beams.

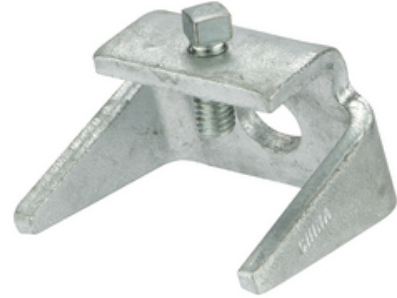

Features

- 3/8" x 1" set screw provides positioning during attachment
- Attachment hole is 11/16" dia.
- Galvanized steel per ASTM A-153
- In compliance with Telcordia GR=3174-CORE specification

General

Catalog Number	PSC2080244
Material	Steel
Type	Messenger
UPC	096359655664

Dimensions

Dimensions	2.740 in x 2.700 in x 2.600 in
Height	2.6 in
Length	2.74 in
Weight	0.627 lb
Width	2.7 in

Logistics

Carton Quantity	50
-----------------	----

Product Assets

[3D Product View - PSC2080244](#)

[Catalogs - Aerial Pole Hardware](#)

[Sales Drawings - B Beam Clamp](#)

[Video - 360° Image](#)



A Hubbell brand