

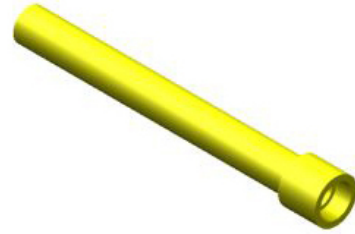

## EFV Model P58 with SERIES 1800

By Gas Breaker  
Catalog # [20122GB](#)

EFV #P58 3/4" IPS SDR11, 2406 W/ 3/4" IPS SKT CPLG, SERIES 1800



### Features

- Work with the flow of natural gas as the sensing source
- Activate when a line rupture causes an excess flow condition
- Automatically reset and resume normal operation after repairs are made using a slight gas bypass to re-pressurize the line. Install in minutes with standard tools
- Operate within your normal service line sizing requirements to avoid tripping by snap-acting loads
- Higher capacity EFVs can accommodate future increases in gas loads.
- Maintain stability under turbulent flow conditions by using a unique, dynamically balanced float
- Available for virtually all pressures and service line capabilities

- In-line installation makes them tamper-proof
- Can be fabricated with fitting and piping materials from most manufacturers

### General

Catalog Number	20122GB
Material	PE Polyethylene (2406/2708)

### Product Assets

[Catalogs - Gas Breaker - Automatic Safety Valves for Gas Service Lines](#)  
[Specifications - 20122GB](#)



A Hubbell brand

©2025 Hubbell Incorporated. All rights reserved  
GSBK-20122GB-SPEC-EN | REV 3/2025