



HINGES AND GLASS LENS COVERS



HINGE-10L and HINGE-10R
HINGE-11L and HINGE-11R
HINGE-12L and HINGE-12R
Extruded Aluminum



HINGE 4 Stainless Steel

Round and Rectangular Lens Covers Must Be Factory Installed



GL/GLX Series Lens Cover

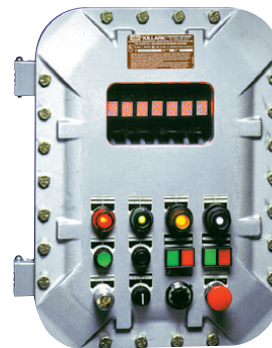

FEATURES-SPECIFICATIONS HINGES

Applications

Hinges are installed on flanged enclosures to allow for easier and safer installation and when performing maintenance on internal components.

| HINGES | | |
|----------------|-------------------|-------------------|
| CATALOG NUMBER | SERIES USED | MATERIAL |
| HINGE-4 | DB | Stainless steel |
| HINGE-12L | Small EXB | Extruded aluminum |
| HINGE-12R | | |
| HINGE-10L | Larger sizes EXB | Extruded aluminum |
| HINGE-10R | | |
| HINGE-11L | Mid Sizes EXB, DB | Extruded aluminum |
| HINGE-11R | | |

Note: Hinge is a single hinge and two required per enclosure.

- Hinge 10L-10R-11L-11R-12L-12R include two hinges
- Hinge 10L, 11L & 12L are for mounting on left side of enclosure
- Hinge 10R, 11R & 12R are for mounting on right side of enclosure
- All hinges supplied with stainless steel mounting screws and pins

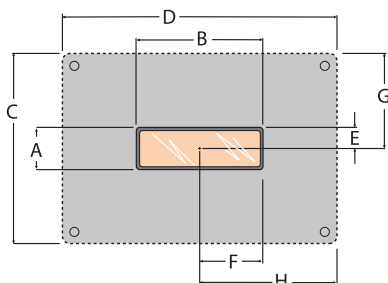

GL/GLX ROUND GLASS LENS COVERS

Applications

Use GL Series lens on:

- All EXB Boxes

Use GLX Series lens on:

- All DB Boxes

Refer to recommended minimum spacing table. Series GL and GLX have identical viewing lens diameter and outside diameter. The difference is in the thread pitch.

GLXR RECTANGULAR GLASS LENS COVERS

Applications

Rectangular glass lens windows can be factory installed to enable viewing of digital read out meters and devices such as:

- Volt meters
- Flow meters
- Gas analyzers
- Process receivers, transmitters and controllers

Ordering Information

Rectangular lens option must be factory installed and ordered in conjunction with appropriate EXB Series enclosure. See page E42. Submit drawing or sketch to specify lens location. Consult factory for multi-lens arrangements.

| GLXR RECTANGULAR LENS COVER ASSEMBLIES | | | | | | | | |
|--|---------------------------|-----------|---------------|--------------|------------------|-------------|--------------|--------------|
| CATALOG NUMBER | VIEWING AREA ^① | | MINIMUM SPACE | | OTHER DIMENSIONS | | | |
| | A | B | C | D | E | F | G | H |
| GLXR13 | 1 (25.4) | 3 (76.2) | 4.5 (114.3) | 6.5 (165.1) | 0.5 (12.7) | 1.5 (38.1) | 2.25 (57.2) | 3.25 (82.6) |
| GLXR24 | 2 (50.8) | 4 (101.6) | 5.5 (139.7) | 7.5 (190.5) | 1 (25.4) | 2 (50.8) | 2.72 (69.1) | 3.75 (95.3) |
| GLXR27 | 2 (50.8) | 7 (177.8) | 5.5 (139.7) | 10.5 (266.7) | 1 (25.4) | 3.5 (88.9) | 2.75 (69.9) | 5.25 (133.4) |
| GLXR34 | 3.5 (88.9) | 4 (101.6) | 7 (177.8) | 7.5 (190.5) | 1.75 (44.5) | 2 (50.8) | 3.5 (88.9) | 3.75 (95.3) |
| GLXR36 | 3 (76.2) | 6 (152.4) | 6.5 (165.1) | 9.5 (241.3) | 1.5 (38.1) | 3 (76.2) | 3.25 (82.6) | 4.75 (120.7) |
| GLXR47 | 4 (101.6) | 7 (177.8) | 7.5 (190.5) | 10.5 (266.7) | 2 (50.8) | 3.5 (88.9) | 3.75 (95.3) | 5.25 (133.4) |
| GLXR59 | 5 (127.0) | 9 (228.6) | 8.5 (215.9) | 12.5 (317.5) | 2.5 (63.5) | 4.5 (114.3) | 4.25 (108.0) | 6.25 (158.8) |
| GLXR99 | 9 (228.6) | 9 (228.6) | 12.5 (317.5) | 12.5 (317.5) | 4.5 (114.3) | 4.5 (114.3) | 6.25 (158.8) | 6.25 (158.8) |

① Other sizes available. Contact the factory for additional information.

| GL/GLX RECOMMENDED MINIMUM SPACING – CENTERLINE TO CENTERLINE | | | | | | | VIEWING DIAMETER | OUTSIDE DIAMETER |
|---|--------------|--------------|---------------|---------------|---------------|---------------|------------------|------------------|
| GLASS LENS TYPE | GL/GLX-275 | GL/GLX-300 | GL/GLX-375 | GL/GLX-537 | GL/GLX-600 | GL/GLX-775 | | |
| GL/GLX-275 | 7 (177.8) | 7.5 (190.5) | 7.75 (196.9) | 8.75 (222.3) | 9 (228.6) | 10 (254.0) | 2.75 (69.9) | 4.63 (117.6) |
| GL/GLX-300 | 7.5 (190.5) | 8 (203.2) | 8.25 (209.6) | 9.25 (235.0) | 9.5 (241.3) | 10.5 (266.7) | 2.93 (74.4) | 5.25 (133.4) |
| GL/GLX-375 | 7.75 (196.9) | 8.25 (209.6) | 8.5 (215.9) | 9.5 (241.3) | 9.75 (247.7) | 10.75 (273.1) | 3.75 (95.3) | 6.25 (158.8) |
| GL/GLX-537 | 8.75 (222.3) | 9.25 (235.0) | 9.5 (241.3) | 10.5 (266.7) | 10.75 (273.1) | 11.75 (298.5) | 5.38 (136.7) | 7.88 (200.2) |
| GL/GLX-600 | 9 (228.6) | 9.5 (241.3) | 9.75 (247.7) | 10.75 (273.1) | 11 (279.4) | 12 (304.8) | 6 (152.4) | 8.88 (225.6) |
| GL/GLX-775 | 10 (254.0) | 10.5 (266.7) | 10.75 (273.1) | 11.75 (298.5) | 12 (304.8) | 13 (330.2) | 7.75 (196.9) | 10.25 (260.4) |

Note: For spacing less than minimum in table, (shown in inches) consult factory.

ENCLOSURES

ENCLOSURE OPTIONS



GLASS LENS COVER

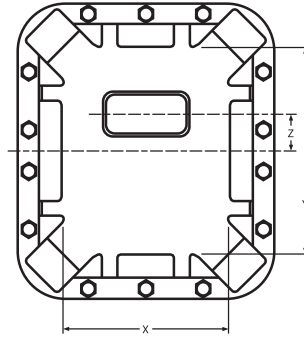

FEATURES-SPECIFICATIONS

GLXR LAYOUT GUIDE

| CATALOG NUMBER | USEABLE COVER AREA | | Z = MAXIMUM CENTER LINE OF COVER TO CENTERLINE OF GLASS LENS | | | | | | | |
|----------------|--------------------|---------------|--|---------------|---------------|---------------|---------------|---------------|---------------|---------------|
| | X | Y | GLXR13 | GLXR24 | GLXR27 | GLXR34 | GLXR36 | GLXR47 | GLXR59 | GLXR99 |
| EXB-664 N34 | 5 (127.0) | 5 (127.0) | N | N | N | N | N | N | N | N |
| EXB-684 N34 | 5 (127.0) | 7 (177.8) | 1.25 (31.8) | N | N | N | N | N | N | N |
| EXB-6124 N34 | 5 (127.0) | 11 (279.4) | 3.25 (82.6) | R | N | N | N | N | N | N |
| EXB-886 N34 | 7 (177.8) | 7 (177.8) | 1.25 (31.8) | 0.75 (19.1) | N | N | N | N | N | N |
| EXB-8104 N34 | 7 (177.8) | 9 (228.6) | 2.25 (57.2) | 1.75 (44.5) | N | 1 (25.4) | N | N | N | N |
| EXB-8106 N34 | 7 (177.8) | 9 (228.6) | 2.25 (57.2) | 1.75 (44.5) | N | 1 (25.4) | N | N | N | N |
| EXB-8126 N34 | 7 (177.8) | 11 (279.4) | 3.25 (82.6) | 2.75 (69.9) | R* | 2 (50.8) | R* | N | N | N |
| EXB-8128 N34 | 7 (177.8) | 11 (279.4) | 3.25 (82.6) | 2.75 (69.9) | R* | 2 (50.8) | R* | N | N | N |
| EXB-10106 N34 | 9 (228.6) | 9 (228.6) | 2.25 (57.2) | 1.75 (44.5) | N | 1 (25.4) | N | N | N | N |
| EXB-10108 N34 | 9 (228.6) | 9 (228.6) | 2.25 (57.2) | 1.75 (44.5) | N | 1 (25.4) | N | N | N | N |
| EXB-10146 N34 | 9 (228.6) | 13 (330.2) | 4.25 (108.0) | 3.75 (95.3) | R | 3 (76.2) | R | R | R | N |
| EXB-10148 N34 | 9 (228.6) | 13 (330.2) | 4.25 (108.0) | 3.75 (95.3) | R | 3 (76.2) | R | R | R | N |
| EXB-12126 N34 | 10 (254.0) | 10 (254.0) | 2.75 (69.9) | 2.25 (57.2) | 2.25 (57.2) | 1.5 (38.1) | 1.75 (44.5) | 1.25 (31.8) | N | N |
| EXB-12128 N34 | 10 (254.0) | 10 (254.0) | 2.75 (69.9) | 2.25 (57.2) | 2.25 (57.2) | 1.5 (38.1) | 1.75 (44.5) | 1.25 (31.8) | N | N |
| EXB-12186 N34 | 10 (254.0) | 16 (406.4) | 5.75 (146.1) | 5.25 (133.4) | 5.25 (133.4) | 4.5 (114.3) | 4.75 (120.7) | 4.25 (108.0) | R* | N |
| EXB-12188 N34 | 10 (254.0) | 16 (406.4) | 5.75 (146.1) | 5.25 (133.4) | 5.25 (133.4) | 4.5 (114.3) | 4.75 (120.7) | 4.25 (108.0) | R* | N |
| EXB-12246 N34 | 10.25 (260.4) | 22.25 (565.2) | 8.88 (225.6) | 8.38 (212.9) | 8.38 (212.9) | 7.63 (193.8) | 7.88 (200.2) | 7.38 (187.5) | R | N |
| EXB-12248 N34 | 10.25 (260.4) | 22.25 (565.2) | 8.88 (225.6) | 8.38 (212.9) | 8.38 (212.9) | 7.63 (193.8) | 7.88 (200.2) | 7.38 (187.5) | R | N |
| EXB-122412 N34 | 10.25 (260.4) | 22.25 (565.2) | 8.88 (225.6) | 8.38 (212.9) | 8.38 (212.9) | 7.63 (193.8) | 7.88 (200.2) | 7.38 (187.5) | R | N |
| EXB-12368 N34 | 11 (279.4) | 35 (889.0) | 15.25 (387.4) | 14.75 (374.7) | 14.75 (374.7) | 14 (355.6) | 14.25 (362.0) | 13.75 (349.3) | R* | N |
| EXB-123610 N34 | 11 (279.4) | 35 (889.0) | 15.25 (387.4) | 14.75 (374.7) | 14.75 (374.7) | 14 (355.6) | 14.25 (362.0) | 13.75 (349.3) | R* | N |
| EXB-14146 N34 | 13 (330.2) | 13 (330.2) | 4.25 (108.0) | 3.75 (95.3) | 3.75 (95.3) | 3 (76.2) | 3.25 (82.6) | 2.75 (69.9) | 2.25 (57.2) | * |
| EXB-14148 N34 | 13 (330.2) | 13 (330.2) | 4.25 (108.0) | 3.75 (95.3) | 3.75 (95.3) | 3 (76.2) | 3.25 (82.6) | 2.75 (69.9) | 2.25 (57.2) | * |
| EXB-16166 N34 | 14 (355.6) | 14 (355.6) | 4.75 (120.7) | 4.25 (108.0) | 4.25 (108.0) | 3.5 (88.9) | 3.75 (95.3) | 3.25 (82.6) | 2.75 (69.9) | 0.75 (19.1) |
| EXB-16168 N34 | 14 (355.6) | 14 (355.6) | 4.75 (120.7) | 4.25 (108.0) | 4.25 (108.0) | 3.5 (88.9) | 3.75 (95.3) | 3.25 (82.6) | 2.75 (69.9) | 0.75 (19.1) |
| EXB-16248 N34 | 14 (355.6) | 22 (558.8) | 8.75 (222.3) | 8.25 (209.6) | 8.25 (209.6) | 7.5 (190.5) | 7.75 (196.9) | 7.25 (184.2) | 6.75 (171.5) | 4.75 (120.7) |
| EXB-162410 N34 | 14 (355.6) | 22 (558.8) | 8.75 (222.3) | 8.25 (209.6) | 8.25 (209.6) | 7.5 (190.5) | 7.75 (196.9) | 7.25 (184.2) | 6.75 (171.5) | 4.75 (120.7) |
| EXB-18186 N34 | 16 (406.4) | 16 (406.4) | 5.75 (146.1) | 5.25 (133.4) | 5.25 (133.4) | 4.5 (114.3) | 4.75 (120.7) | 4.25 (108.0) | 3.75 (95.3) | 1.75 (44.5) |
| EXB-18188 N34 | 16 (406.4) | 16 (406.4) | 5.75 (146.1) | 5.25 (133.4) | 5.25 (133.4) | 4.5 (114.3) | 4.75 (120.7) | 4.25 (108.0) | 3.75 (95.3) | 1.75 (44.5) |
| EXB-18248 N34 | 16 (406.4) | 22 (558.8) | 8.75 (222.3) | 8.25 (209.6) | 8.25 (209.6) | 7.5 (190.5) | 7.75 (196.9) | 7.25 (184.2) | 6.75 (171.5) | 4.75 (120.7) |
| EXB-182410 N34 | 16 (406.4) | 22 (558.8) | 8.75 (222.3) | 8.25 (209.6) | 8.25 (209.6) | 7.5 (190.5) | 7.75 (196.9) | 7.25 (184.2) | 6.75 (171.5) | 4.75 (120.7) |
| EXB-18308 N34 | 16 (406.4) | 29 (736.6) | 12.25 (311.2) | 11.75 (298.5) | 11.75 (298.5) | 10 (254.0) | 11.25 (285.8) | 9.75 (247.7) | 9.25 (235.0) | 8.25 (209.6) |
| EXB-18368 N34 | 16 (406.4) | 34 (863.6) | 14.75 (374.7) | 14.25 (362.0) | 14.25 (362.0) | 12.25 (311.2) | 13.75 (349.3) | 12.25 (311.2) | 11.75 (298.5) | 10.75 (273.1) |
| EXB-183610 N34 | 16 (406.4) | 34 (863.6) | 14.75 (374.7) | 14.25 (362.0) | 14.25 (362.0) | 12.25 (311.2) | 13.75 (349.3) | 12.25 (311.2) | 11.75 (298.5) | 10.75 (273.1) |
| EXB-203611 N34 | 18.88 (479.6) | 34.88 (886.0) | 15.18 (385.6) | 14.68 (372.9) | 14.68 (372.9) | 13.93 (353.8) | 14.18 (360.2) | 13.68 (347.5) | 13.18 (334.8) | 11.18 (284.0) |
| EXB-24248 N34 | 22 (558.8) | 22 (558.8) | 8.75 (222.3) | 8.25 (209.6) | 8.25 (209.6) | 7.5 (190.5) | 7.25 (184.2) | 7.25 (184.2) | 6.75 (171.5) | 4.75 (120.7) |
| EXB-242410 N34 | 22 (558.8) | 22 (558.8) | 8.75 (222.3) | 8.25 (209.6) | 8.25 (209.6) | 7.5 (190.5) | 7.25 (184.2) | 7.25 (184.2) | 6.75 (171.5) | 4.75 (120.7) |
| EXB-24308 N34 | 22 (558.8) | 28 (711.2) | 11.75 (298.5) | 11.25 (285.8) | 11.25 (285.8) | 9.5 (241.3) | 10.75 (273.1) | 9.25 (235.0) | 9.75 (247.7) | 7.75 (196.9) |
| EXB-24368 N34 | 22 (558.8) | 34 (863.6) | 14.75 (374.7) | 14.25 (362.0) | 14.25 (362.0) | 12.5 (317.5) | 13.75 (349.3) | 13.25 (336.6) | 12.75 (323.9) | 10.75 (273.1) |
| EXB-243610 N34 | 22 (558.8) | 34 (863.6) | 14.75 (374.7) | 14.25 (362.0) | 14.25 (362.0) | 12.5 (317.5) | 13.75 (349.3) | 13.25 (336.6) | 12.75 (323.9) | 10.75 (273.1) |

Symbols: N = Enclosure will not accommodate this lens size
 R = Rotate lens 90°, consult factory for layout assistance

• = Voids UL/CSA/CENELEC certifications
 * = Indicates center line