



Harsh & Hazardous

KILLARK®

KBQA Series

DRAIN BREATHER

for Harsh and Hazardous Environments





KBQA SERIES DRAIN BREATHER



- Class I, Div. 1 and 2, Groups B, C, D
- Class I, Div. 1 and 2, Groups B*, C, D
- Class I, Zone 1, AEx d IIB+H2 Gb
Class II, Div. 1 and 2, Groups E, F, G
Zone 22, AEx tb IIIC Db, IP66
Class III
Ambient Temperature Range -50°C to +60°C
Enclosure Type 3,4 4X and IP66
File LR11716
- II 2 G D
Ex db IIB+H2 Gb
Ex tb IIIC Db IP66
Service Temperature Range -50°C to +60°C
SIRA 10ATEX1351U
IECEX CSA 10.0007U

* Enclosures having a maximum volume of 28L

FEATURES-SPECIFICATIONS

Applications

A drain fitting provides the valuable means to prevent the water produced from condensation from building up inside of an enclosure. When installed in the bottom of an enclosure the KBQA allows water to drain continuously out of the enclosure. The KBQA when installed in the top or sides of the enclosure acts as a breather allowing air to flow in. The air flow prevents a vacuum from forming inside the enclosure which can impede the flow of the built up water through the drain.

Features

- Supplied standard with a 1/2" NPT thread.

Materials

- The external body is offered in two materials, 6061-T6 aluminum and 316 stainless steel for the Type 4X rating.
- The internal sintered arrester is nickel plated brass.

CATALOG NUMBER	MATERIAL
KBQAAL0050	6061-T6 Aluminum
KBQAS60050	316 Stainless Steel

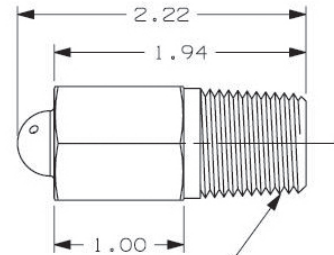
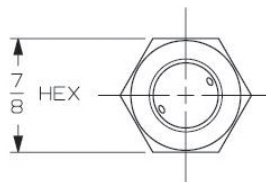

1/2-14 NPT
THREAD SPEC.
PER ANSI B1.20.1