

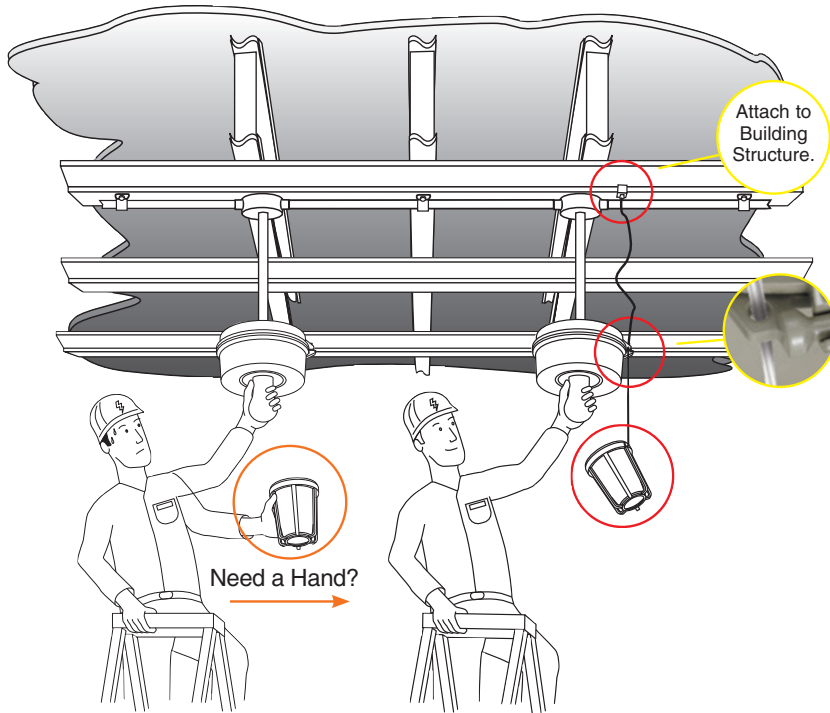

ACCESSORIES/REPLACEMENT PARTS



CERTILITE DESIGN
LIGHTING DESIGN SOFTWARE

POWERFUL
Luminaire Layout and
Calculation Software



Software is used to determine number of fixtures required and their proper layout for various tasks and applications.

Contact your local Killark sales representative for availability.

SUSPENSION DEVICES①		
TANK	DESCRIPTION	CATALOG NUMBER
VM GLOBE & GUARD UNITS	"3rd hand" safety kits. 24" stainless cable holds globe using guard for lamp change out. Attaches to tank's built-in "Earthquake Tab".	VMAGSC①
VM (ALL TANKS)	10' Stainless Steel Safety Cable with loop grip. Drop limit 1'. Attaches to "Earthquake Tab" and to building structure (e.g. I-beam)."	VMSC10

① VM2, VM4 and VM5 units require VMAGBC bottom closure, sold separately, in addition to guard.

DARK SKY KITS		
VMDARK1	Gasket Kit	On VM1, VM2, VM3, VM4 "Full Cutoff" when used with HRD400 or HRD400ALZ On VM5 "Cutoff" when used with HRD400 or HRD400ALZ
VMER40	Gasket Kit	Enclosed Reflector "Full Cutoff" on VM2/VM4/VM5 as standard

Note: CertiLite® V luminaires may be configured for "Full Cutoff", or Semi-Cutoff photometric distribution.

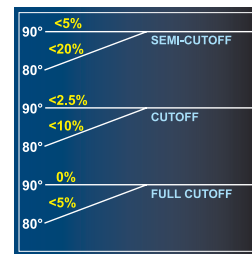

Competitive adapters for upgrading existing fixtures to Killark, see VM mounting and adapter grid, page L222 for more information.

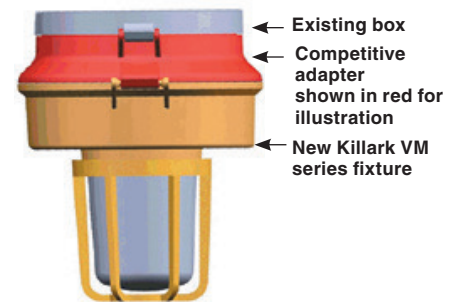

MISCELLANEOUS PARTS	
0735015B	Mogul Socket VM3, VM4, VM5
VMBNKIT	Barrel nut and long bolt adapts older CertiLite tanks to newer CertiLite® mounts.

FUSE KITS
See catalog logic for factory installed fuses, or page L141-L142 for field installation kits.

Crouse-Hinds is a registered trademark of Crouse-Hinds.